



# JEANNEAU SUN ODYSSEY 380

## SPECIFICATIONS

Overall length without bowsprit	11,22 m	36'9"
Overall Length with bowsprit	11,75 m	38'6"
Hull length	10,77 m	35'4"
Waterline length	10,71 m	35'1"
Beam	3,76 m	12'3"
Displacement light load with deep draft keel	6 896 kg	15 203 lbs
Standard keel draft	2,00 m	6'6"
Standard keel weight	1 810 kg	3 990 lbs
Shoal keel draft	1,56 m	5'3"
Shoal keel weight	1 972 kg	4 348 lbs
Lifting keel draft	1,32-2,70 m	4'3"- 8'10"
Lifting keel weight	1 607 kg	3 543 lbs

Fuel capacity	130 L	34 US gal
Water capacity	330 L	87 US gal
Fridge capacity	160 L	42 US gal
Holding tank capacity	80 L	21 US gal
Standard mainsail horizontally-cut in High Strength polyester	35,10 m <sup>2</sup>	378 Sq ft
Furling 110 % genoa in high strength polyester	28,30 m <sup>2</sup>	317 Sq ft
CE category	A8 / B8 / C10 / D10	
Architect / Designer	Marc Lombard Yacht Design Piaton Bercault & Co Jeanneau Design	

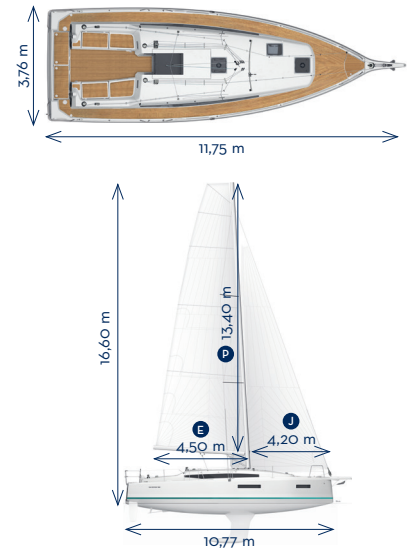

## AN EXCEPTIONAL LEVEL OF EQUIPMENT

### EXTERIOR

#### Sailing features

- Rig
- Harken® roof and primary winches
- Harken® deck hardware
- Anodized aluminium mast and boom
- Boom with rigid boom vang and lowered gooseneck, to ease maneuvering
- Semi-battened mainsail and furling genoa with UV protection
- Discontinuous standing rigging, stainless steel wire
- Lazy bag and lazy jacks
- Sheets lead back to the helm - German sheeting
- Large choice of sails sets

#### Construction

- Single skin hull, hand-laid fibreglass, ISO gelcoat surface, protective "barrier coat"
- Infused fibreglass inner liner, easy access to grounding frame, relamination in stays attachment areas
- Prisma Process® injected deck, ISO gelcoat surface, discontinuous balsa block coring - 30 % weight savings as compared to traditional decks
- Twin rudders with self-aligning roller bearings and textile lines, to increase control and pleasure in navigation
- Negative bow: allows to increase waterline length while improving the fineness of the water lines
- The bow rises out of the water: reduce submerged surface in light winds

#### Cockpit

- Leather-covered stainless steel steering wheels
- Telescopic bath scale
- Hinged companionway doors

#### Deck

- Flush deck hatches
- Long tinted acrylic roof windows
- External woodwork and inlays
- Mid-ship cleats
- Lifelines

### INTERIOR

- One-level interior with no door sills
- Leather-wrapped handrails
- LED lighting
- Large, rectangular double berths
- Fully-upholstered hull sides
- Blinds for each hatch and opening in the forward and aft cabins
- Numerous choices of interior ambiances
- Large seaworthy storage spaces, seaworthy with fiddles, soft closing drawers and cabinets
- Shower separate (wet area) from toilet in 2 cabins version

#### Chart table

- Large navigation desk with leatherette lining and interior storage for a portable computer, electrical panel and books storage

#### Galley

- L-shape galley
- Laminate white counter top
- Double stainless steel sinks
- 2-burner stove with oven
- Fridge 160 L / 42 US gal

#### Sofa Lounge

- Convivial and comfortable sofa lounge
- Reinforced armrest for comfort at heeling

#### Woodwork

- Woodwork in Alpi® Teak or grey Cedar
- UV stabilised varnish
- Ceruse light or dark Oak laminate floorboards
- Numerous solid wood or Alpi® mouldings

### TECHNICAL

#### Electrical

- LED navigation and anchoring lights at the masthead
- 12 V backlit electrical panel
- Lead battery Exide Dual Marine (AGM)
- 125 Ah alternator and charge distributor/isolator
- Positive and negative battery cut-off switches to better protect battery banks

#### Water System

- Hot water heater 250 L / 7 US gal
- "Heavy-duty" water pump

#### Engine

- Fixed 3-blade propeller
- Sound insulation, with fire retardant film

## TRIM LEVELS AND PACKS

### I TRIM LEVEL

	"PREMIERE"	"PREFERENCE"
Counter top in Corian®, with fiddles	•	•
GRP bowsprit with integrated anchor roller	•	•
Second windlass control with chain counter	•	•
Electric windlass 12 V 1000 W Quick® link 10 mm	•	•
Power 220 V / 110 V depending specifications of countries	•	•
USB plugs (5)	•	•
Navicolor battery monitoring	•	•
2-burner cooker and oven with grill function (replaces standard 2 burner cooker)	•	•
Additional service batteries (2 x 100 Ah / 12 V)	•	•
40 Ah battery charger	•	•
Halyard bags in the cockpit (2)		•
Indirect LED lighting, and lamps on bulkheads		•
LED courtesy lighting in the cockpit		•
Upholstered bulkheads		•
Wine storage locker under floorboards (6 bottles)		•
Signature clock and barometer set at the chart table		•
• Shades for windows and ports in the saloon, and 3rd porthole in aft cabin		•

## EXTERIOR AND TECHNICAL EQUIPMENT

### I ARCHITECTURE

- Full-length chine for improved stability and speed
- Long waterline for better speed while sailing and under power
- L-shaped cast iron keel less exposed to seaweed and lines
- Twin rudders with self-aligning roller bearings and textile lines, to increase control and pleasure in navigation
- Negative bow: allows to increase waterline length while improving the fineness of the water lines
- The bow rises out of the water: reduce submerged surface in light winds

### I SAILS

#### Standard

- Mainsail horizontally-cut in High Strength polyester, with UV protection
- Semi-battened mainsail with 2 reefs and UV protection 35,10 m<sup>2</sup> / 378 Sq ft
- 110 % furling genoa with UV protection 28,30 m<sup>2</sup> / 305 Sq ft

#### Options

- In mast furling main sail horizontally-cut in High Strength polyester 30,40 m<sup>2</sup> / 327 Sq ft
- 110 % furling genoa in High Strength polyester with UV protection 28,30 m<sup>2</sup> / 301 Sq ft
- Self-tacking jib (95%) with UV protection in High Strength polyester 21,2 m<sup>2</sup> / 228 Sq ft
- Code 0 in CZ30 laminate for standard mast, 56,2 m<sup>2</sup> / 605 Sq ft, with continuous line furling gear (requires Downwind pack)

### I SAIL HANDLING

#### Standard

- Mainsheet attached to Dyneema® bridle forward of companionway, with sheets lead back to the cockpit winches (german sheeting)
- Adjustable genoa sheet friction rings in cockpit
- Spinlock® jammers
- Coachroof winch 1 x Harken® 35.2 ST to port

- Genoa winches 2 x Harken® 40.2 STA winches for easy use at the helm stations
- Harken® winch handle

#### Options

- Self-tacking jib ball bearing track on coachroof
- Electrical coachroof winch Harken® 35.2 ST, port side only
- 2 x electrical primary winches Harken® 40.2 STA
- Extra Harken® 35.2 ST winch to starboard on coachroof (in Downwind pack)

### I MAST AND RIGGING

#### Standard

- Classic mast in anodised aluminium with double spreaders, deck-stepped
- Aluminium boom with rigid vang and lowered goose neck for easier handling
- Genoa furler with double slot, furling line lead aft to cockpit on coachroof
- Running rigging: topping lift, mainsail halyard, genoa halyard, mainsheet, genoa sheets... in polyester
- Standing rigging discontinuous 1 x 19 stainless steel wire
- Genoa lead rings adjustable with 3D adjustment
- Asymmetrical lazy bag with integrated lazy jacks

#### Option

- Furling mast aluminium with double spreaders, deck-stepped

### I COCKPIT

#### Standard

- Walk-in access to side decks, enabling to walk around the deck without crossing any steps
- Teak inlay on bench seat
- Coaming with ideal height for comfort and safety
- Cockpit lockers: 1 drained on port side, 1 impermeable on starboard side (or access to the workshop), 1 liferaft locker with open access to transom platform 92 x 60 x 42 cm / 3' x 2' x 14", 1 locker for gaz box on the cockpit floor
- Universal gas box, cut-off valve under the stove
- Wheels with leather wrap, space for flush mounted

GPS at each helm

- Emergency tiller, and fitting in cockpit floor
- Engine control: throttle lever at starboard helmstation and oriented engine panel oriented to port
- Hinged companionway doors in plexiglass
- Sliding hatch in plexiglass

#### Options

- GRP cockpit table with foldable sides
- Wooden cockpit table with foldable sides
- Wooden inlay on cockpit floor
- Large cockpit sprayhood, Sunbrella®, high transparency windscreen and LED cockpit lighting
- Cockpit bimini with stainless steel bows in Sunbrella®, foldable with storage cover
- Cockpit enclosure kit in Sunbrella®, fitted on the sprayhood and bimini
- Large bathing platform 0,76 x 2,30 m / 2'5" x 7'6", with telescopic ladder and handrail

### I DECK HARDWARE

#### Standard

- Bow pulpit in stainless steel
- Stern pushpits in stainless steel with buoy bracket
- Double level of stainless steel lifelines
- 6 aluminium mooring cleats
- Stainless steel handrails on coachroof (2)
- Deep anchor locker
- Long fixed tinted windows along coachroof
- Large, fixed hull ports (4)
- Opening ports in the roof (2)
- Opening deck flush hatches (3)
- Opening ports towards cockpit in the aft cabins (1 per cabin)
- Opening ports towards side-deck in the aft cabins (1 per cabin)

### DOWNWIND PACK

- Spinnaker rigging with Spinlock® jammer
- Halyards and sheet for asymmetrical spinnaker / Code 0 (2 polyester halyards, 1 sheet and 1 tack line in Dyneema®, pulleys on mast step and side decks)
- Extra Harken® 35.2 ST winch to starboard
- Extra winch handle
- Windex 15" on mast head

### PERFORMANCE PACK

- Downwind pack
- Performance full-batten mainsail, in DCX® grey, 2 automatic reefs 39,80 m<sup>2</sup> / 428 Sq ft
- 110 % Performance genoa, in DCX® grey, with Sunbrella® UV protection and stainless steel eyelets 28,90 m<sup>2</sup> / 311 Sq ft
- Dyneema® low-stretch halyards and sheets for main and genoa
- Composite steering wheels lighter than stainless steering wheels
- FlatDeck genoa furler

### VOYAGER PACK

- High transparency sprayhood with LED lighting Sunbrella®
- Outboard engine bracket
- Releasable forestay + deck fittings
- 80 W solar panel on coachroof with charging relay
- Seawater foot pump in the galley
- Stainless steel davit arch

### ENTERTAINMENT PACK AUDIO

- RA70N Fusion audio player (Radio / USB / Bluetooth...) at chart table
- Pioneer® speakers 5" in the saloon
- Fusion® waterproof speakers 6" in the cockpit

### Options

- Rubrail for hull protection
- Mooring kit: 6 fenders and 4 docklines
- Anchoring kit with Delta 20 kg / 44 lbs, 32 m / 104' of 10 mm chain and 45 m / 147' of 18 mm line

### LIGHTING

- Full LED interior lighting

### ELECTRICAL

#### Standard

- Main 12 V electrical panel at the chart table with backlight, switches for domestic systems, USB plug and switches
- 12 V Circuit for domestic and engine system
- Domestic battery bank capacity 2 x 100 Ah / 12 V
- Engine start battery capacity 1 x 50 Ah / 12 V
- 12 V engine alternator: 125 Ah
- Positive and negative battery switch 12 V in the aft port side cabin

#### Options

- Lithium domestic battery bank 1 x 90 Ah / 12 V
- USB plug in each cabin
- Inverter 12 V > 220 V 2 000 W enable to use 220 V appliance from the domestic battery bank

### PLUMBING

#### Standard

##### FRESH WATER

- Hot and cold pressurized water circuit with semi-rigid plastic pipes
- "Heavy-duty" water pump (18,5 L / 5 US gal / mn), accumulator tank for consistent water pressure
- Water roto moulded tank: 330 L / 87 US gal, under the forward cabin berth
- Tank gauges
- Water boiler 25 L / 7 US gal connected to the engine and 220 V circuit
- Hot and cold cockpit shower on transom

##### GREY AND BLACK WATER

- Electrical shower pumps
- Large marine toilets with hand pump
- Black water tank 80 L / 21 US gal, with gravity drain and deck fitting

##### BILGES DRAINAGE

- Electric bilge pump located in bilge area with activation via switch at electrical panel
- Dual-action manual bilge pump located in the cockpit, with separate hose from primary bilge pump

##### GAS

- Gas leakage detector

#### Options

- Black water tank 50 L / 13 US gal, with gravity drain and deck fitting (versions C and D)
- Electric Quiet-Flush toilets, on seawater circuit, in place of manual toilets
- Water intake in the cockpit. Enable to connect the fresh water circuit directly to the shore

### ENGINE

#### Standard

- Yanmar Engine 3JH40 Common Rail Shaft Drive - 40 HP / 29 kW - Alternator 125 Ah - control panel at the helm station
- Engine panel oriented toward helmsman, located on the cockpit table. Throttle at the starboard helm station
- Insulation: foam, with fire retardant film
- Built-in muffler, air ventilation and stainless steel exhaust fitting
- Fixed 3-blade propeller
- Ventilation system extractor fan located near the engine, benefiting from the insulation of the engine room. Outlets vents at the back of cockpit
- Roto moulded fuel tank (130 L / 34 US gal) located under the aft cabin berth, fuel / water separator
- Access behind steps to engine compartment and from aft cabins

#### Options

- Retractable bow thruster SE40 125 mm with a dedicated 12 V battery bank under the berth in the front cabin
- Flex-o-Fold 3 blade folding propeller

## INTERIOR EQUIPMENT AND LAYOUTS

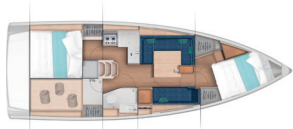

**Version A**  
Forward Owner's cabin,  
1 aft cabin / 1 head

Layout in lifting keel version

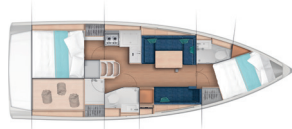

**Version B**  
Forward Owner's cabin,  
1 aft cabin / 2 heads

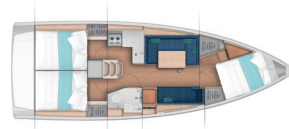

**Version C**  
Forward Owner's cabin,  
2 aft cabins / 1 head

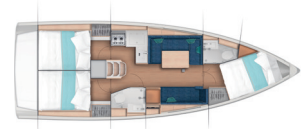

**Version D**  
Forward Owner's cabin,  
2 aft cabins / 2 heads

### WOODWORK

#### Standard

- Alpi® Teck interior woodwork laminated with solid wood trim, UV stabilized varnish
- Fully-upholstered hull sides and ceiling
- Light ceruse Oak laminate floorboards

#### Options

- Woodwork in Alpi® grey Cedar mat finish, open-pore varnish
- Dark Oak laminate floorboards

### SALOON

#### Standard

- Comfortable seating arrangement to port side with view of sea through hull ports
- Hinged storage compartments under settee
- Large storage behind backrests
- Large table with 2 removable aluminium legs
- Convertible berth in saloon
- Large locking storage drawer

#### Options

- "Luxe" folding table: with 1 foldable leave and 1 foldable with 2 positions (high and low)

### SOFA LOUNGE

- Comfortable starboard sofa lounge
- Numerous and voluminous storage spaces

### CHART TABLE

- Large chart table with leatherette worktop opening compartment, for laptop computer, backlighting electrical panel, USB socket
- Multiple storage for telephone, keys...
- Bicolour reading light

### GALLEY

- U-shape galley located on port side, with view on the sea
- Laminate white counter top, with fiddles
- Double stainless steel sinks with chrome fixtures. Sink cover and anti projection board, in Laminate white
- Soft-close, fully-extending drawers
- Waste bin 26 L / 7 US gal
- Open storage under the counter top
- 2-burner stove with protective handrail
- Fridge 160 L / 42 US gal
- Opening hatch above the stove

### COMFORT

#### Standard

- Cushions in High Density foam 130 mm in the saloon
- High Density mattresses in cabins

#### Options

- Cruisair® air conditioning working from generator or shore power with 2 units (24 000 BTU in total)
- Pushed air heating system 5 500 W with outlets in each cabin and aft head

### FORWARD OWNER'S CABIN

#### Standard

- Large domestic size, 2,00 x 1,35 m / 6'6" x 4'5"
- Large hanging locker on port side with LED lighting
- 2 large storage areas at the head of the berth
- LED lighting
- Opening deck hatch, for light and ventilation
- 2 large fixed hull ports with sliding blinds
- Deck hatches with blind and bug screens
- Large additional storage on port side with concealed book shelves

#### Options

- Forward cabin head (versions B and D): en-suite compartment with direct access from the owner's cabin, GRP sink furniture with base cabinet, storage cabinet with shelves, large mirror on the bulkhead, large deck hatch for light and ventilation, indirect LED lighting, shower, shower drain with automatic switch, water inlet valve and connector underneath the sink, large marine toilet with manual pump, hook
- Fully upholstered front bulkhead
- Mattress battens
- Electric Quiet-Flush toilets, on seawater circuit, in place of manual toilets

### AFT CABIN(S)

#### Standard

- Large domestic size, berth 2,00 x 1,82 m / 6'6" x 5'11" (versions A and B)
- Large domestic size, berths 2,00 x 1,50 m / 6'6" x 4'11" (versions C and D)
- Hanging locker storage shelf along hull
- LED lighting
- LED reading lights
- 1 opening port towards the cockpit, 1 opening port towards the side decks
- Blinds for each opening
- Access to tanks on starboard and technical area on port side
- Aft head: access from the saloon, GRP sink furniture with base cabinet, storage cabinet with shelves, large mirror on the bulkhead, large roof window, opening port for light and large roof window, indirect LED lighting, shower, shower drain with automatic switch, water inlet valve and connector underneath the sink, large marine toilet with manual pump, hook

### WORKSHOP ON STARBOARD (versions A and B)

- Sail locker located to starboard aft of the separate shower, double access from the interior and the cockpit
- LED lighting
- Access to the tank under the main cabinet
- Lateral storage locker

## HEADROOM

Forward cabin	1,92 m	6'3"	Galley	1,97 m	6'5"
Aft cabin(s)	1,97 m	6'5"	Aft starboard head	1,86 m	6'1"
Companionway	1,94 m	6'4"	Forward head	1,82 m	5'11"
Saloon	2,01 m	6'7"			

