

Sun Odyssey

490



S U M M A R Y

- SPECIFICATIONS
- KEY POINTS
- EXTERIOR
- INTERIOR
- TRIM LEVEL
- PACKAGES
- SAILS
- CONSTRUCTION
- UPHOLSTERY
- VINYL HULL WRAP
- BATTERIES
- ELECTRONIC PACKAGES
- AST OPTION



JEANNEAU

> SPECIFICATIONS

Prism  Process



TECHNICAL INFORMATIONS

Overall length with bowsprit: 14,8 m / 48'6"
 Overall length: 14,42 m / 47' 3"
 Hull length: 14 m / 45' 11"
 Waterline length: 13,24 m / 43' 5"
 Beam: 4,49 m / 14' 8"

Displacement light load with deep draft keel:.....
 11.290 kg / 24.890 lbs
 Standard keel draft: 2,24 m / 7' 4"
 Shoal keel draft: 1,65 m / 5' 4"

Cabins: 2 / 3 / 4 / 5
 Berths:..... 4 / 6 / 8 / 9 (+2)

Engine power:Yanmar Sail Drive 57 Hp / 42 kW
 Yanmar Sail Drive/Docking 80 Hp / 59 kW
 Fuel capacity: 240 l / 63 US gal
 Water capacity: 640 l / 169 US gal
 Cold capacity: 190 l / 50 US gal

Sail area:
 - Standard 110,4 m² / 1188 Sq ft
 - Performance 121,5 m² / 1307 Sq ft

CE category: A
 Architects: Philippe Briand
 Piaton Bonet Yacht Design - Jeanneau Design

VERSIONS • LAYOUTS

Fixed keel version
 Shoal draft version

2 cabins / 2 heads
 3 cabins / 2 heads
 4 cabins / 4 heads (available in summer 2018)
 5 cabins / 3 heads (available in summer 2018)

Interior woodwork in Alpi® Teak or
 Alpi® Grey Cedar

Offshore cruiser, elegant and very comfortable

EXTERIOR

Comfort and performance for passagemaking:

- Powerful, balanced and modern hull designed by Philippe Briand, that combines a long waterline length and a hard chine for speed and comfort at sea.
- Sleek deck lines, safe and ergonomic with flush hatches and integrated running rigging.
- Sail plan with a high aspect ratio. Multiple choices including: self-tacking jib, large overlapping genoa, Code 0, furling mast, etc...
- Safe and ergonomic cockpit with lines led back to helm stations.
- Innovative deck plans, with inclined slide deck for an easy circulation.

Relaxation and aesthetics:

- Large cockpit with full-function table
- Fold-down transom for easy access to the sea and sundeck (option).
- Sleek deck with curved windows, flush panels and integrated running rigging and sundeck (option).
- Extending coamings convertible into lounging area

INTERIOR

Lighting, volume and ventilation:

- A multitude of ports and hatches for ventilation and light
- 3 distinct zones in the saloon designed to allow each to be used independently without constricting movement throughout the interior
- A functional chart table
- Light and luxury down below with solid wood, mat varnish, polished-stainless steel, leather and a full selection of interior fabrics.
- A safe and central galley in sailing

Lots of features:

- All the key features of the Sun Odyssey range concentrated on the same boat
- Plenty of choices available: Different interior layouts, sail plans, keel and fabrics allow each owner a high level of personalisation
- Choice of woodwork :Alpi® Teak or Alpi® Grey Cedar

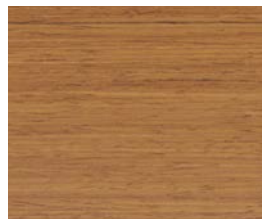

Alpi® Teak



Alpi® Grey Cedar

HULL AND KEEL: modern and balanced

- **Philippe Briand design**
- **Deep keel** (2.24 m / 7'4") or shoal keel (1.65 m / 5'5")
- **Twin rudders** with self-aligning roller bearings and textile lines.
- **Hard chine on hull** creates stability and enhances interior volume.
- **Long water line** provides performance under sail and power.
- **Moderate freeboard** lends a beautiful and sleek look to the hull along with the 8 hull ports and hard chine.

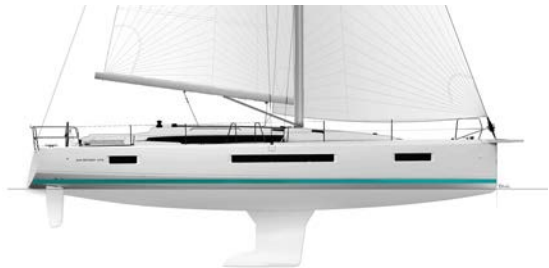

DECK AND COCKPIT: Liveability, comfort and safety

- **Twin helm steering moved far aft**, keeps the cockpit clear and gives easy access to the transom.
- **Harken deck hardware:** winches, blocks, tracks designed to make sail handling ease from the helm.
- **Easy access to the sea** thanks to a wide drop-down aft platform in standard.
- **Large cockpit table** with storage, lighting and icebox.
- **Flush hatches and integrated running rigging** gives the deck a sleek look and makes movements onboard safer.
- **Lots of storage:** 2 lateral lockers, 2 large lockers under the helm stations, 1 large locker that can be used for the optional generator, a liferaft locker. Forward sail locker and a deep anchor locker.



DECK

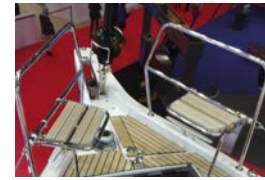
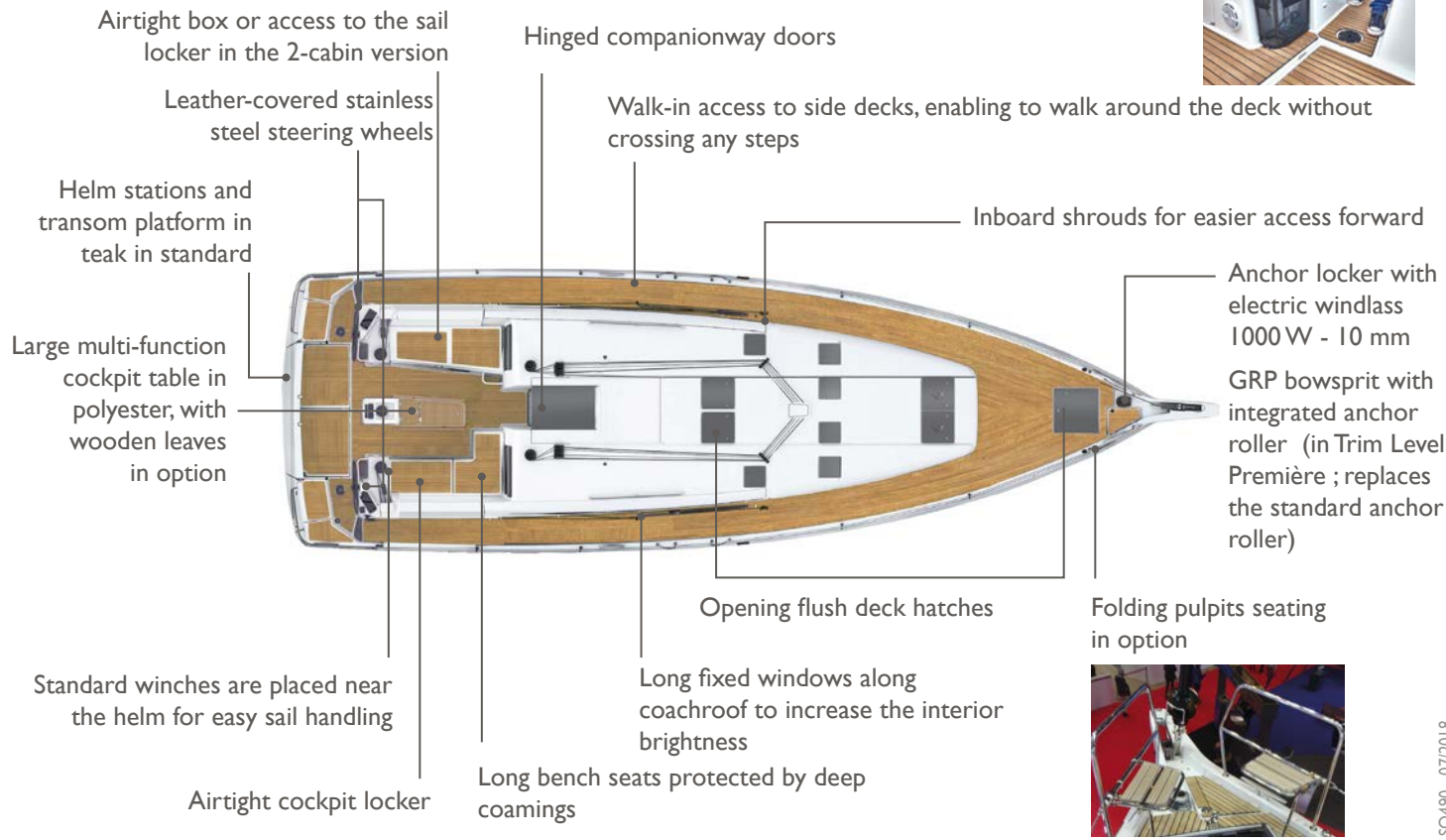

COCKPIT

Large aft fold-down swim platform with telescopic ladder. Opening system electric, with 2 remote controls, optional



A large locker on the cockpit floor that can be used for the optional generator



Fixed coamings with ideal height for comfort and safety. Extending coamings convertible into lounging area, in option. Cushions for cockpit available for each set up



Gas locker: scalable for 2 bottles of 2.7 kg / 6 Lbs or a large 13 kg / 29 Lbs bottle

Space for flush mounted GPS at each helm

Halyard bags in the cockpit with stainless steel frame, at each helm

Opening and fixes large hull ports for light and ventilation



Space provided for liferaft, easily accessible



COCKPIT (continued)

The coamings:

Innovative on this type of sailboat, extending coamings are convertible into lounging area.

This ergonomic prowess allows to benefit from a unique relaxation zone on a 49-foot boat.



Multi-function cockpit table:

- Throttle lever
- Engine panel
- Bottle storage
- Cup holders
- Compass
- Ice box
- Optional portable 12V fridge in the cockpit table



COCKPIT (continued)

Large cockpit sprayhood, with high transparency windscreen and LED cockpit lighting. Cockpit bimini with stainless steel bows, connecting fabric between bimini and sprayhood. The bimini is fixed on the stern pulpits.

Cockpit enclosure kit, fitted on the sprayhood and bimini allowing to close the cockpit without losing traffic on the side decks.

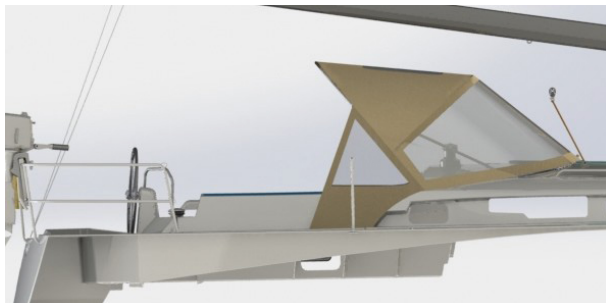

Sprayhood

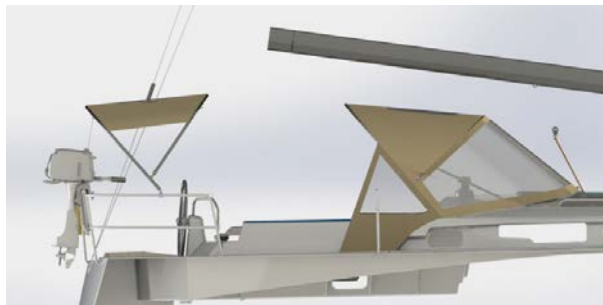

Sprayhood and bimini

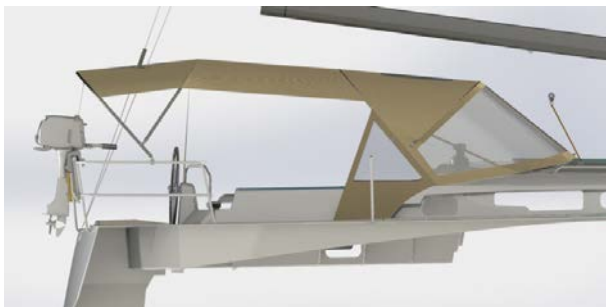

Sprayhood, bimini and connecting fabric

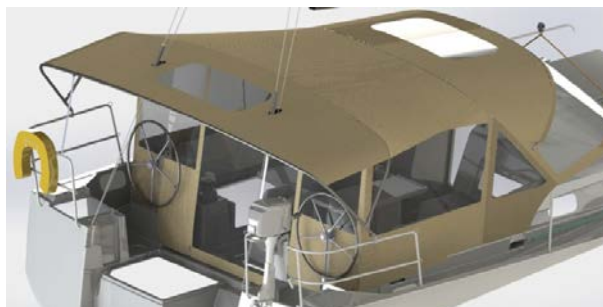

Sprayhood and cockpit enclosure kit

RIGGING



Here is the track system used by Sun Odyssey 449. Putting the boom in the axis requires adjustment of the track with each tack.

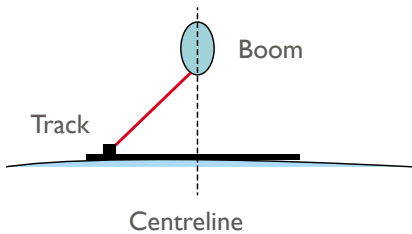

Y-bridle system used by the Sun Odyssey 490. By bringing the pulleys closer to the boom, the bridle allows for good boom angulation, similar to that of a Mainsail track without any adjustments to be made during the tacks.

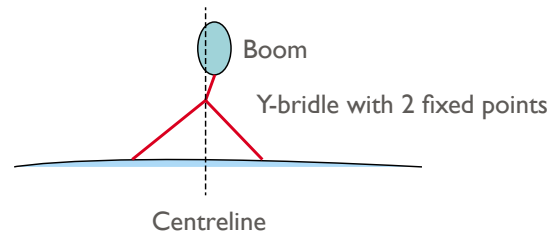

A TRULY MULTIPURPOSE BOWSPRIT

Better look:

- Modern and elegant
- Sculpted fiberglass part flows into hull lines



Better anchoring:

- Stainless steel anchor fitting is positioned further from the bow to ensure more clearance
- Anchor roller is closer to the centerline for easier anchoring and retrieval and less hunting when at anchor
- Fixed, metallic bobstay protects the bow and stays out of the way when anchoring



Better sailing:

- 1 - Reinforced attachment point for Code 0
- 2 - Additional tack point attachment at the end of the bowsprit for larger asymmetric spinnakers

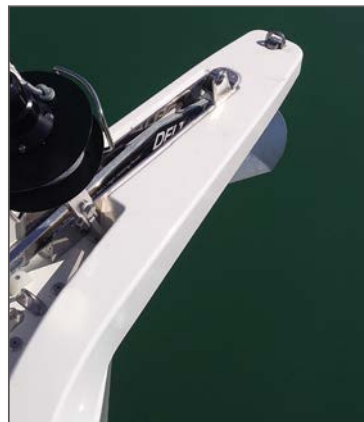

SAIL PLAN - STANDARD - HIGH STRENGTH SAIL



SAIL PLAN - CATHEDRAL RIGGING

Cathedral rigging:

2 levels of spreaders but 4 anchoring points on the mast.

Allows you to have the same mast hold as a rigging with 3 levels of spreaders, without dunnage, overweight and the complexity of adjusting a three-stage rigging.

Split rigging:

The inboards shrouds (D1) have been retracted to offer a better traffic on the side decks, and to allow genoa with greater overlap.

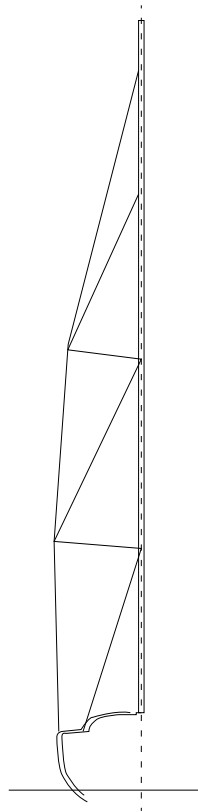

SAIL PLAN - PERFORMANCE

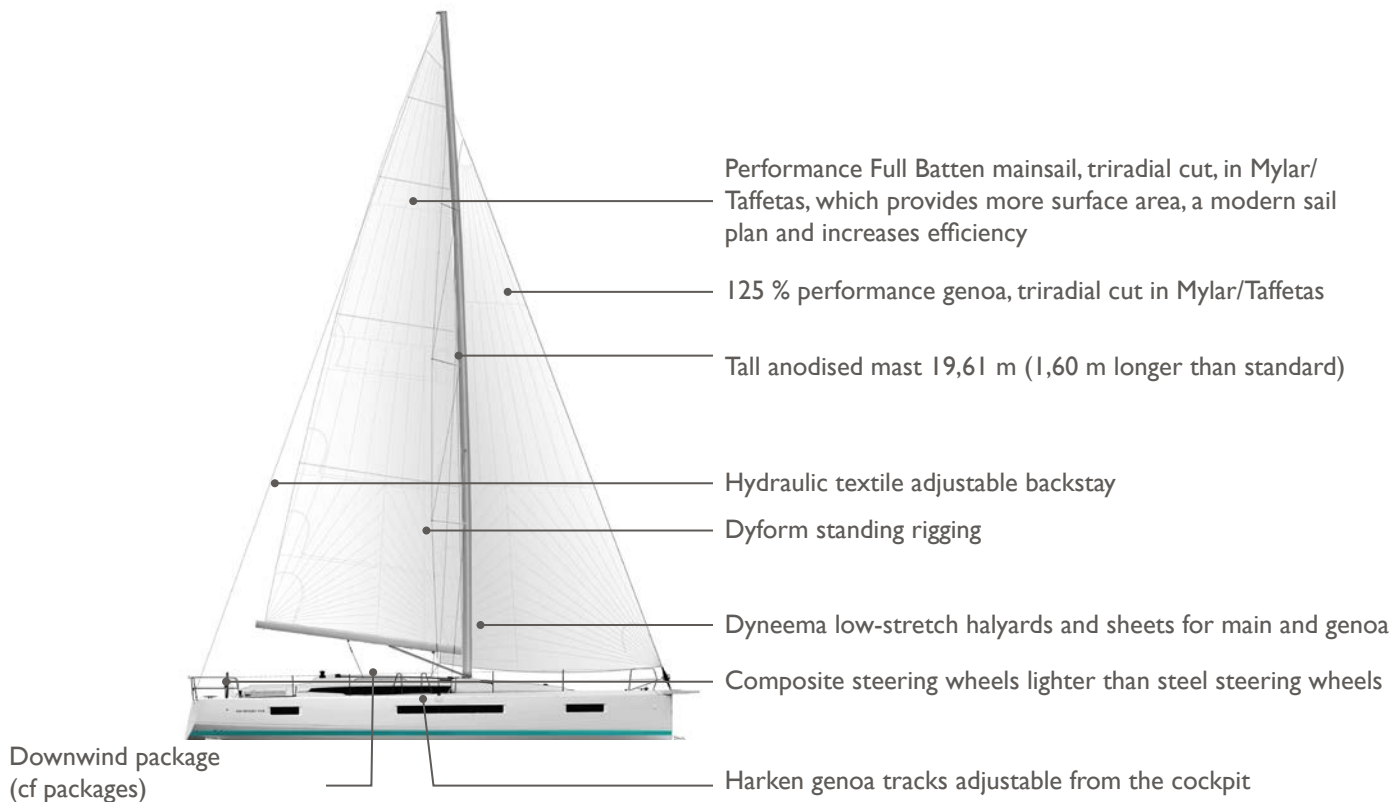

INTERIOR FEATURES: VOLUME, STYLE AND COMFORT

Modern and performante hull

Benefits: performance thanks to the powerful hull and volume of the cross-section

Spacious interior with choice of 3 different interior layouts.

A maximum of services in the saloon, with real dedicated living areas, a multitude of practical and aesthetic details and an easy circulation, one-level interior with no door sills.

8 large and fixed hull ports, long fixed and curved windows along coachroof, 6 opening ports and 6 flush deck hatches

Benefits: ventilation, right natural lighting and views of the sea.

2 cabins ans 2 heads with a workshop

Benefits: double access from the interior and the cockpit, the workshop can accommodate additional appliances.

3 cabins and 2 heads version

Each cabin offers the same comfort with 1,60 x 2 m (5'3" x 6'7") beds.

4 or 5 cabins versions

The solution for the most numerous crews and charter companies

LED lighting

Wood options:

INTERIOR WOOD



FLOOR

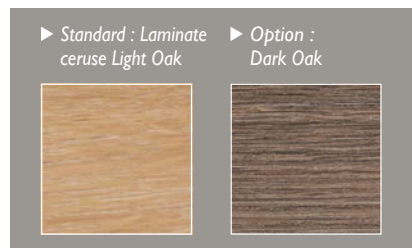

INTERIOR LAYOUTS

2 cabins / 2 heads version



4 cabins / 4 heads version (available in summer 2018)



3 cabins / 2 heads



5 cabins / 3 heads version (available in summer 2018)



SALOON

LED lighting

Large hull ports create lots of light and provide views of the sea

TV LED 32" in option

Central two-seat bench with storage

Indirect LED lighting



Leather-wrapped handrails



Companionway with only 4 steps

Large storage with leatherette lining and fiddles, between the saloon and the companion way

SALOON

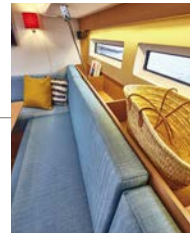

Long fixed windows along coachroof to increase the interior brightness

Large storage behind backrests



Storage space under the bench



Bottles storage



Large table with 2 removable aluminium legs, for up to 6 persons
("Deluxe" folding table on telescopic legs in option)

Convertible berth in saloon
(option including 2 short legs)

GALLEY

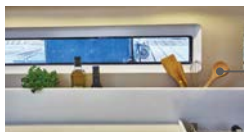

Open storage behind the galley

2 burner stove with protective handrail in standard.
3 burner cooker and oven with grill function in option

Counter top in Corian®, with fiddles

Push-up micro wave, in option



Waste bin 26 L / 7 US gal under the sink

Double stainless steel sinks with chrome fixtures

Large drawer in the centre cabinet, with leatherette top finish



Soft-close, fully-extending cutlery drawers

Wine storage locker under floorboard



GALLEY (continued)

Waste bin 26 L / 7 US gal



Fridge 190 L / 50 US gal with top opening for better cold storage.
Cooler door available en Trim Level Préférence



Push-up micro wave under the work surface, in option



In option, Extra fridge drawer 75 L / 20 US gal or extra freezer drawer 75 L / 20 US gal 12V

CHART TABLE ON PORT SIDE

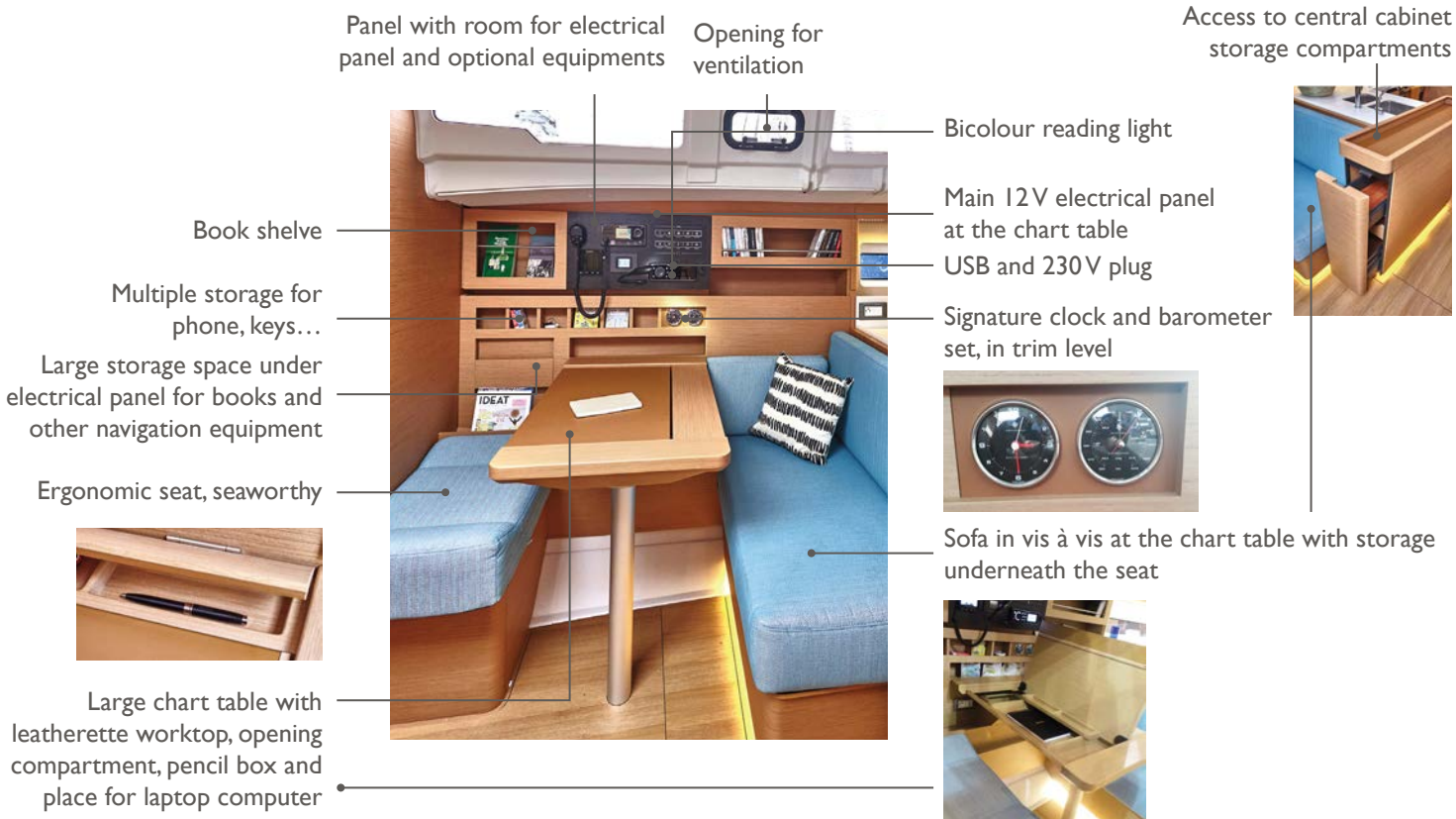

FORWARD CABIN



Large fixed hull ports with sliding blinds

Large mirror in front of the cabin that brings more depth



LED Lighting

Side bed tables and lower locker with leatherette top finish

Double berth 2,00 m x 1,60 m (6'7" x 5'3") with high density Premium mattress and lateral access (Mattress battens in option)

3 large drawers underneath the berth, for more storage space (2 drawers if air-conditioning option)

FORWARD CABIN



FORWARD CABIN

Separate shower compartment in front of the sink and behind the TV cabinet.

Located in the centre of the boat for higher headroom.

Dedicated opening deck hatch and plexiglas door



Large drawer under the sink to range accessories and beauty products



GRP sink furniture

Deep shelves with fiddles



Separate manual toilet compartment to port, with GRP sink furniture.

Electric toilets in option.

Hull port allowing sea view, opening deck hatch for light and ventilation.

2 CABINS VERSION

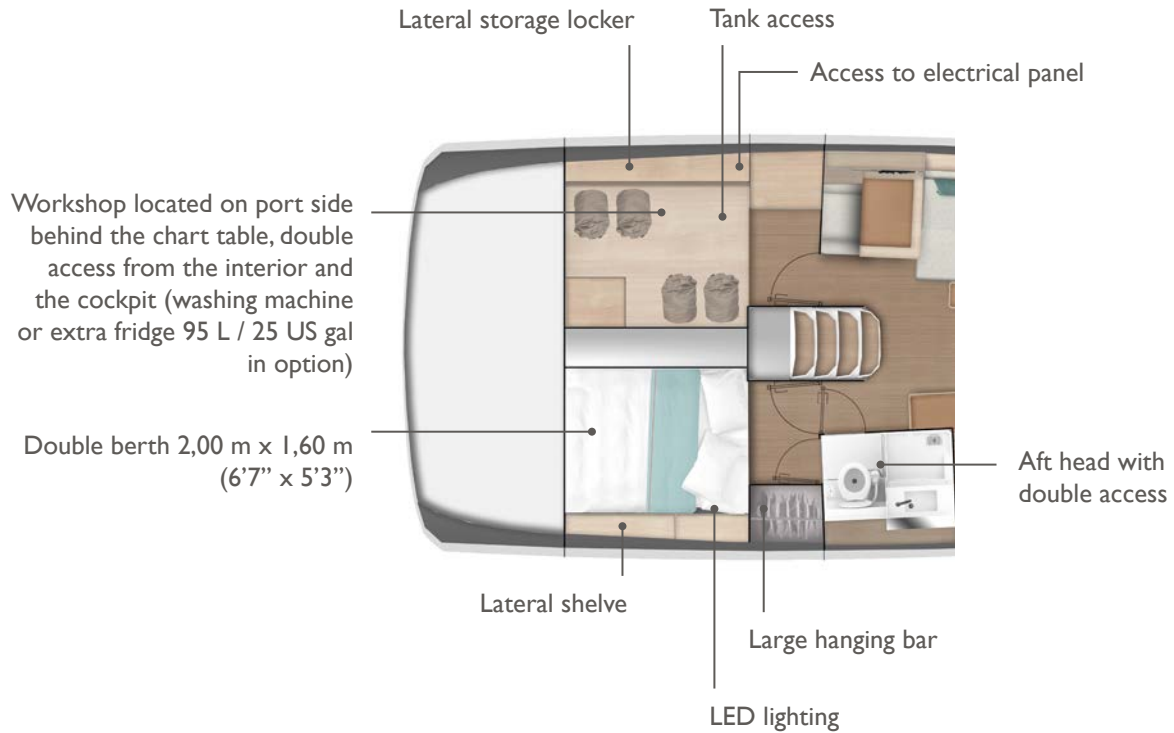

AFT CABIN - STARBOARD HEAD

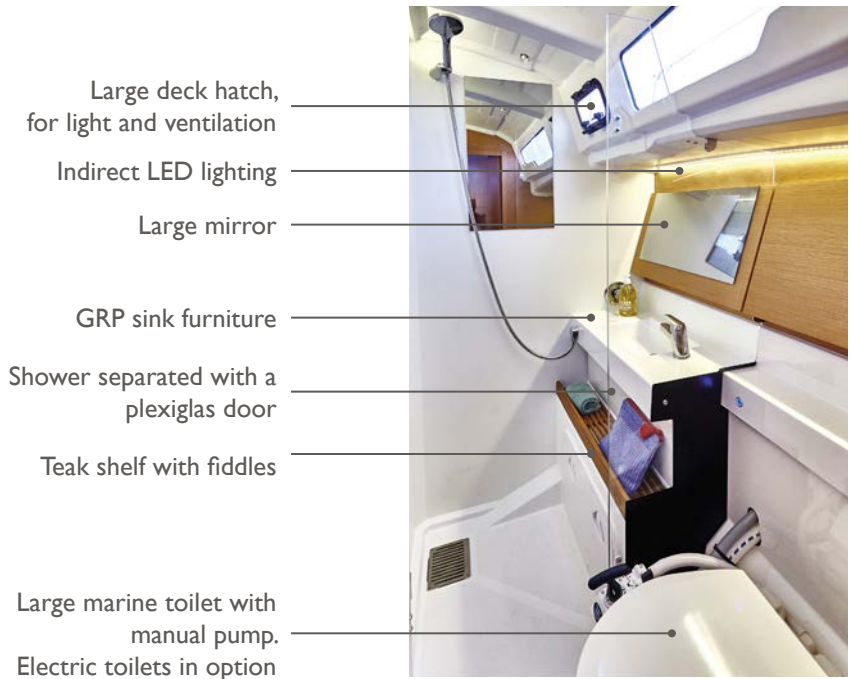

Storage with towel shelf

3 CABINS VERSION



Light and ventilation provided by large opening hatch and an opening port with sliding blinds

Double berths 2,00 m x 1,60 m (6'7" x 5'3") with high density Premium mattress

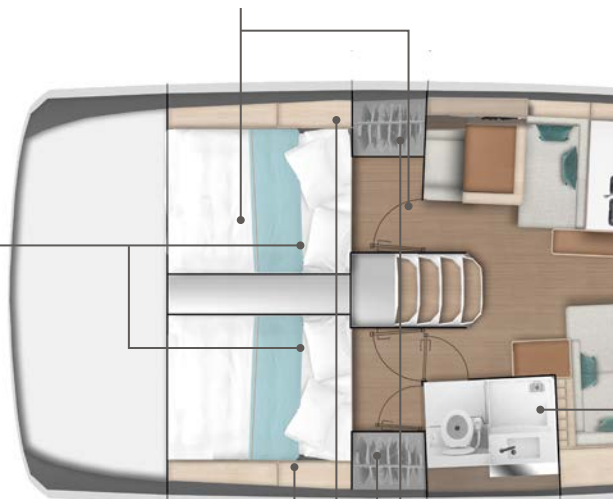

Aft head with double access

Lateral shelves, offering more storage space

Large hanging bar

4 CABINS VERSION (available in summer 2018)

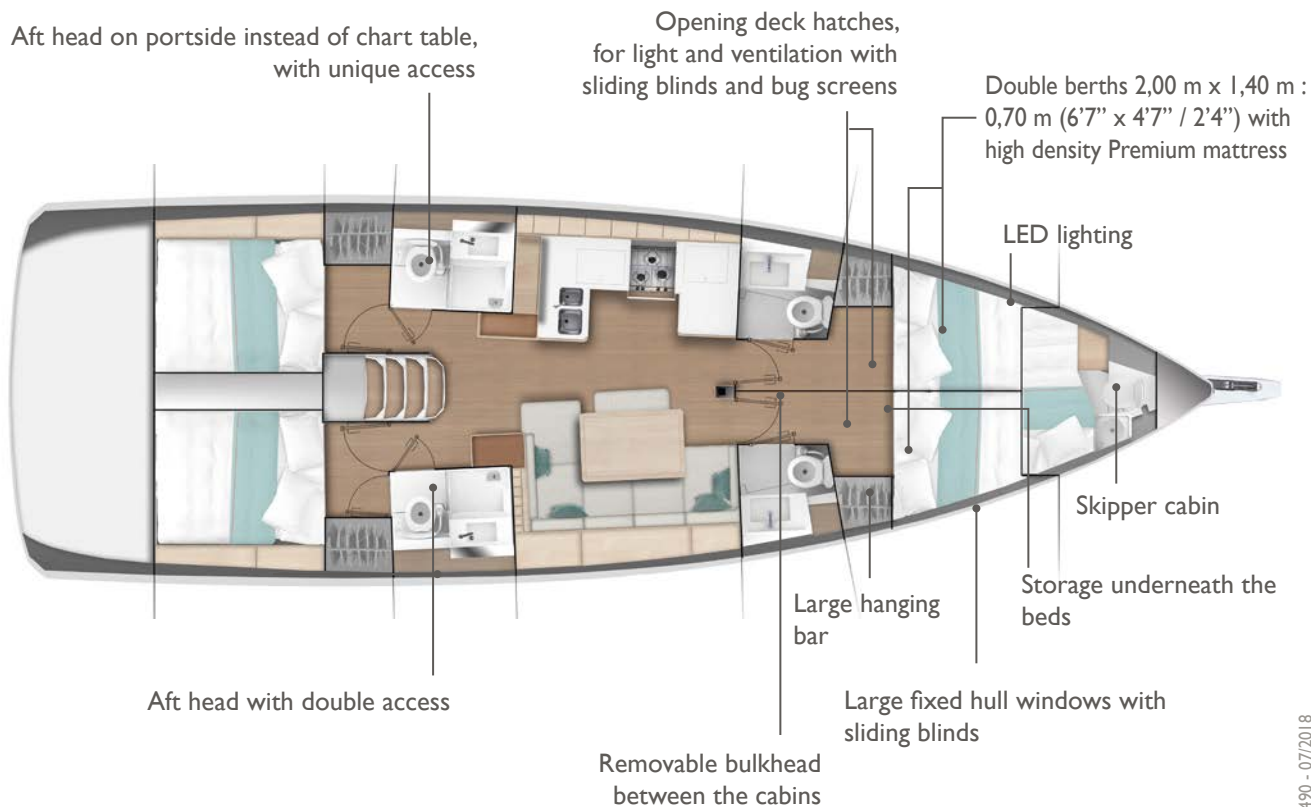

5 CABINS VERSION (available in summer 2018)

Forward layout same as 4 cabins version

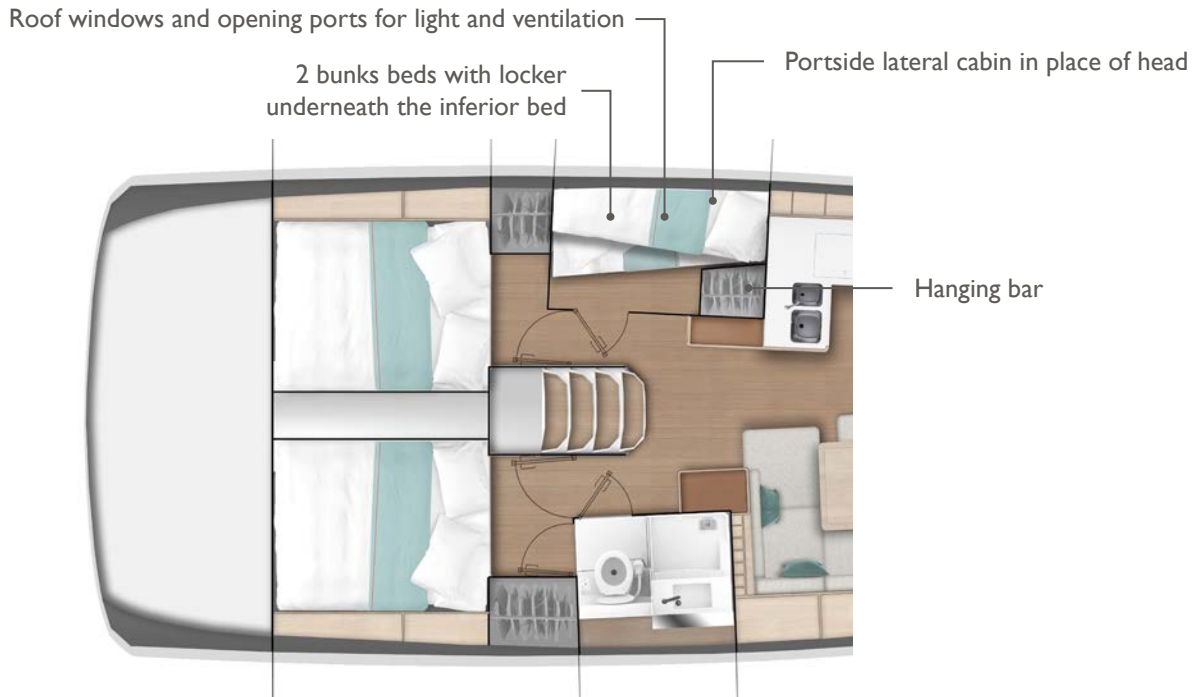

PREMIERE TRIM LEVEL : ALL VERSIONS



Halyard bags in the cockpit with stainless steel frame



40 A battery charger for 12V battery banks

GRP bowsprit with integrated anchor roller

Mid ship cleats

LED courtesy lighting in the cockpit

Halyard bags in the cockpit with stainless steel frame



Protective GRP eyebrow for the long acrylic roof windows

Second windlass control with chain counter, installed in the cockpit

3 burner cooker and oven with grill function

Navicolor battery monitoring

Additional service batteries 2 X 115 Ah



SO490 - 07/2018

PREFERENCE TRIM LEVEL : 2 AND 3 CABINS*

*Préférence trim level includes Première trim level



Shades and screens for hatches in the saloon

Sound deadening lining in cabinets



Upholstered bulkheads



Indirect LED lighting, and lamps on bulkhead

Shades for windows and ports in the saloon

Specific compartment for cutlery in the central galley storage unit

Signature clock and barometer set at the chart table



Wine storage locker under floorboards



PERFORMANCE PACKAGE*

*Performance package includes Downwind package

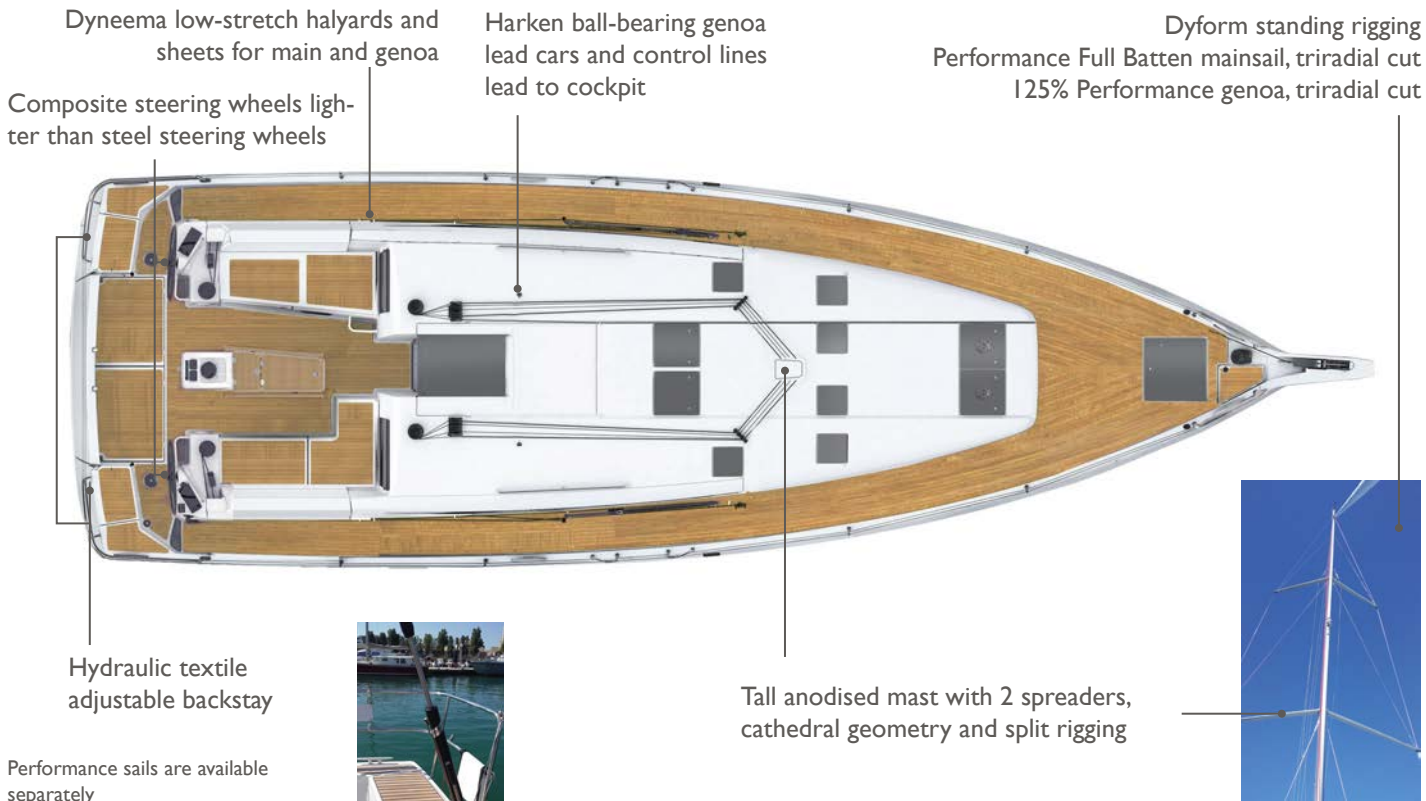

DOWNWIND PACKAGE

Halyards and sheet for asymmetrical spinnaker / Code 0 (2 polyester halyards, 1 sheet and 1 tack line in Dyneema®, pulleys on mast step and side decks)

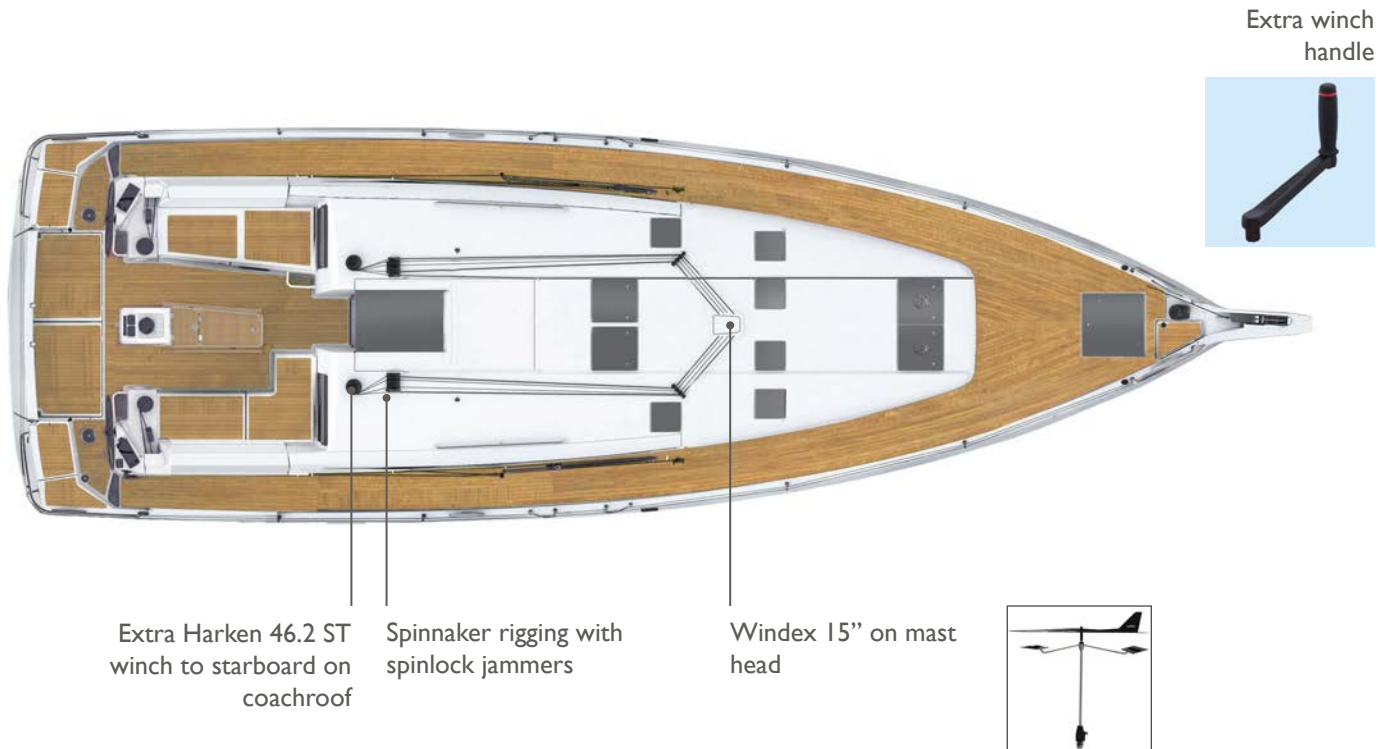

Extra Harken 46.2 ST winch to starboard on coachroof

Spinnaker rigging with spinlock jammers

Windex 15" on mast head

Extra winch handle



ENTERTAINMENT AUDIO PACKAGE

RA70N Fusion player
(Radio / USB / Bluetooth...)
at the chart table



Bose® speakers in the saloon +
Bose® subwoofer under settee

Speakers in the cockpit



ENTERTAINMENT VIDEO PACKAGE - EXCLUSIVELY IN 2 OR 3 CABINS VERSIONS

MS-AV750 Fusion DVD player
(CD / DVD / USB / Bluetooth...)
at the chart table



Bose® speakers in the
saloon + Bose® subwoofer
under settee



Speakers in the cockpit



TV LED 32" in the saloon +
TV antenna for mast fitting



TV LED 22" in owner's cabin



VOYAGER PACKAGE - EXCLUSIVELY IN 2 OR 3 CABINS VERSIONS

High transparency sprayhood
with LED lighting -
Sunbrella® Plus Taupe/Oyster



Outboard engine bracket

Releasable forestay + deck fittings

Solar panel on coachroof
with charging relay



CONVERTIBLE COCKPIT PACKAGE

Extending coamings convertible into lounging area



Starboard infill cushion for I-seating area - Sunbrella® Sling Taupe or Sunbrella® Natté Oyster

Cushions for cockpit and sunbathing areas



EXTERNAL GALLEY PACKAGE

Cockpit sink with hot & cold water



Portable 12V fridge in the cockpit table



SAIL AND RIG PLANS: SAILS for every sailor

Select the sail plan that best fits your style:

- **High aspect ratio rig** for maximum performance while limiting the loads on the sheets.
- **Inboard shrouds and genoa tracks** allow better trim and easy circulation on the side decks.
- **Code 0** offered as an option for sailing in light wind conditions.

SPECIFICATIONS

SEMI FULL BATTENED MAINSAIL :

- Dacron®
- Horizontal panels
- Stainless steel eyes
- UV-stabilised thread
- Draft stripe
- Radial reinforcements
- Adjustable leech line
- Loose-footed
- 3 reef points each with singleline reefing system
- **Area: 56,60 m² (609,23 Sq ft)**



SHORT OVERLAPPING FURLING GENOA (125%) :

- Dacron®
- Horizontal panels
- UV-stabilised thread
- Webbing strap at head
- Bolt-rope for furler
- Anti-UV protection on foot and leech
- Draft stripe
- Webbing strap at tack
- Reefing marks
- Adjustable leech line
- **Area: 53,60 m² (576,95 Sq ft)**



BENEFITS

- High-aspect rig for maximum performance
- Easy to handle sail plan
- Versatile and balanced sail plan at all sailing angles

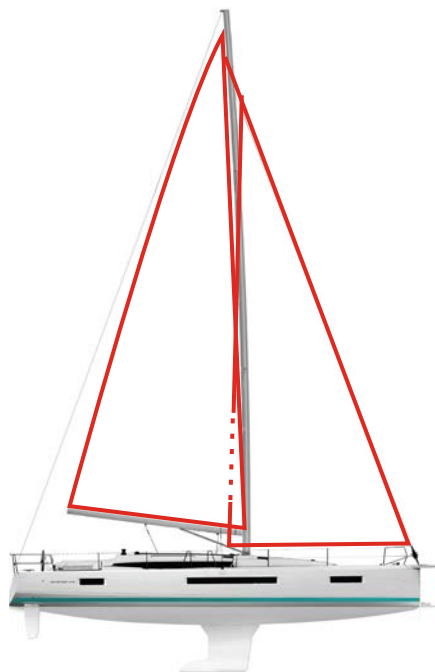

I = 16,60 m / 54'6"
 J = 5,70 m / 18'8"
 P = 16,80 m / 55'1"
 E = 5,80 m / 19'00"

PERFORMANCE VERSION

PERFORMANCE MAINSAIL:
62,68 m²

PERFORMANCE GENOA: 58,82 m² (633,13 Sq ft)

Tall anodised mast 19,61 m / 64'4"
(1,60 m / 5'3" longer than standard)

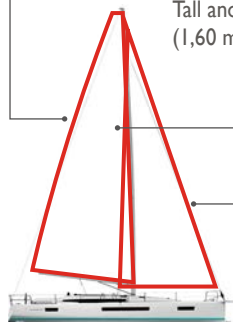

A LA CARTE OPTIONS

FURLING MAINSAIL: 45,22 m² (486,74 Sq ft)

SELF-TACKING JIB: 37,82 m² (407,09 Sq ft)

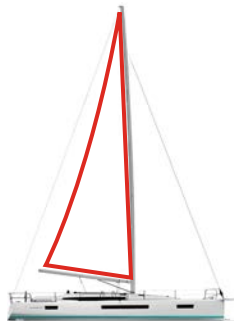

PERFORMANCE SAILS : MYLAR TAFFETAS X-GRID

Working in collaboration with Dimension-Polyant and Technique Voiles, Jeanneau has developed a new Mylar Taffeta X-Grid® fabric for the Performance range.

The tri-radial construction of the sail contributes to superior shape holding, but other forces can act on the individual panels. By using a specially-designed X-Grid® of fibres angled at 6° laminated into the fabric, better bias control can be achieved which makes the sail more resistant to deformation and aging.

The performance of these new fabrics provides a more stable sail cloth that is lighter, easier to handle, with better shape control over time.

These new Performance sails are easily recognisable; they include a taffeta laminate that is light grey that gives them a very “hi-tech” look.

- 1 - Protective taffetas
- 2 - Polyester film
- 3 - X-Grid® fibres
- 4 - Polyester scrim

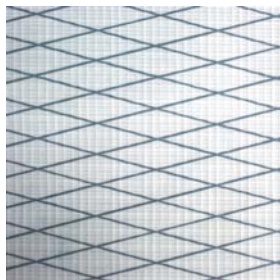

SPECIFICATIONS

FURLING MAINSAIL:

- Polyester High Strength
- Horizontal panels
- UV-stabilised thread
- Radial reinforcements
- Draft stripe
- Adjustable leech line
- UV protection at sheet attachment
- Replaces the standard mainsail
- Included in furling mast option
- **Area: 45,22 m² (486,74 Sq ft)**



BENEFITS

- Easy handling
- Quick furling of the sail
- Easy reefing
- Same height as the classic mainsail
- Compatible with classic genoa or self-tacking jib

SPECIFICATIONS

FOC AUTOVIREUR ENROULEUR :

- Polyester High Strength
- Horizontal panels
- UV-stabilised thread
- Webbing strap at head
- Bolt-rope for furler
- Anti-UV protection on foot and leech
- Draft stripe
- Radial reinforcements
- Webbing strap at tack
- Adjustable leech line
- Replaces the standard genoa
- Requires deck hardware for self-tacking jib
- **Area: 37,82 m² (407,09 Sq ft)**



BENEFITS

- Hands-free tacking
- Great up-wind performance
- Perfect for short-handed sailing

SPECIFICATIONS

CODE 0

Selden continuous line furler:

- Laminate Mylar/Aramid X-Grid fabric in light grey
- Triradial cut
- Anti twist luff cord
- UV-stabilised thread
- Straps for sheet attachment
- Adjustable leech and foot lines
- Requires rigging for asymmetrical spinnaker / Code 0
- **Area: 95.58 m² (1028,81 Sq ft) for classic mast**
102.3 m² (1101,15 Sq ft) for tall mast



BENEFITS

- A light wind sail designed for use between 60° and 120°
- Continue to sail when others have given up and turned on the motor
- Continuous line furler allows easy deployment and furling from the cockpit
- Ideal addition to boats with small overlapping jibs and self-tacking jibs



CODE 0: MYLAR ARAMID X-GRID

For the development of the new Code 0 sails on a continuous line furler, Jeanneau selected a sail cloth that is perfectly adapted for use in light airs.

Highly resistant, light weight and able to be furled, the Mylar Aramid X-Grid has a light grey finish that is translucent.

Unidirectional Aramid fibres, vacuum-bagged together between two polyester films, provide an unequalled resistance to weight ratio. This ultra light sail is easy to handle and fills with the slightest puff of wind.

Adding the X-Grid® polyester fibres at a 6° angle provides excellent bias control in all directions and improves sail shaping, as well as, resistance to tearing.

Lastly, a taffeta is added to the external laminate of the sail cloth to protect the sail from ultraviolet light and wear during furling or storage.

The Code 0 sails from Jeanneau integrate these high-performance materials to meet the exacting demands of our owners. In addition to these high-end materials, the look of these sails sets Jeanneau apart.

- 1 - Polyester film
- 2 - X-Grid® fibres
- 3 - Unidirectional Aramid fibres
- 4 - Protective taffeta

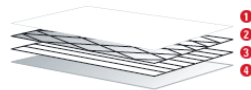

SO490 - 07/2018

PRISMA PROCESS



Leader in vacuum bagging technology for the construction of racing boats, JTA developed an resin injection process applicable to the construction of cruising boats. By using advanced engineering, precisely positioned layers of glass fabric and mat and specially developed core materials, Jeanneau is able to mould a deck to exacting tolerances.

Jeanneau's leadership in this domain gives it a substantial advantage over its competitors and ensures unequalled quality to the customer.

This 21st century technology allows Jeanneau to manufacture complex fibreglass parts with:

- Perfect finish on both sides (no need for a counter mould)
- Reduced weight (providing the sailboat better stability/performance)
- Increased strength and rigidity of the piece (quality of lay-up)
- Reduction by 90% of VOC emissions (environmentally-friendly)
- Optimum working conditions for the production team (no contact with resins/catalysts)
- High quality parts (precise control of gelcoat, core materials and resin injection)

The deck of the Jeanneau 54 is the largest mass-produced injection fibreglass part in the world.

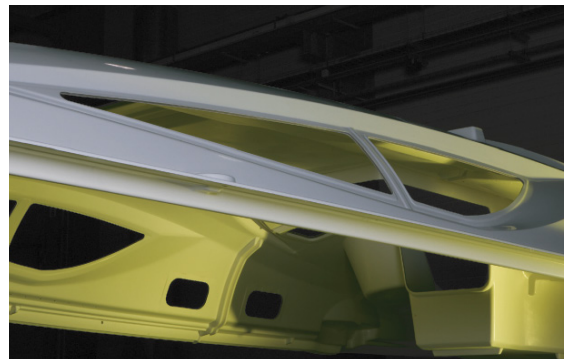

COUNTER-MOULDING

3rd generation hull structure

Jeanneau has long been known for strong and seaworthy boats. Today the technology of boatbuilding has evolved, but our commitment to this tradition has not wavered. The Jeanneau 3rd Generation Hull Structure combines the latest in fiberglass technology with modern yacht design to deliver a structural reinforcement perfectly adapted to the demands of the offshore sailor.

- ❶ High-load zones cut-out for access to the hull
- ❷ Integrated repair area at aft end of keel
- ❸ Structure is precisely placed in the hull
- ❹ Glued and relaminated to the hull for strength
- ❺ Acts as a support for the floorboards
- ❻ Keel bolts located near vertical members and through counter mould and hull
- ❼ Limber holes at hull level for efficient drainage
- ❽ Counter mould remains below level of floorboards and is not visible

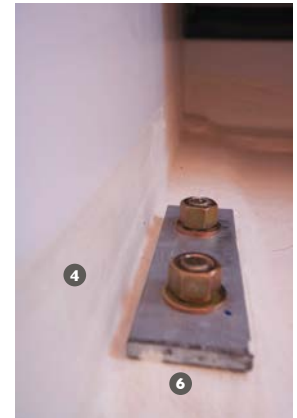

ALPI WOOD

SALES POINTS:

Environmental:

- Ayous (Triplochiton scleroxylon - Sterculiacées) trees in managed forests of indigenous hardwoods are selected and cut, with a constant care given towards long term preservation of natural resources.
- Teak and other soft rainforest woods often come from geopolitically sensitive regions and are not managed in a sustainable way.

Quality:

- These ALPI wood panels are substantially more expensive and reliable than standard marine plywood. They are used by top of the line furniture manufacturers, as well as many exclusive super-yacht builders (for example Azimut and Ferretti only use ALPI wood).
- Consistency of finish and colors throughout the boat.
- Elimination of “defects” in wood panels.

Durability:

- Harder finish that is more resistant to humidity.
- Better resistance to UV.
- Easier repairs as veneer is tinted through and through so clear varnishes can be used.



SALOON : 9 choices possible



STANDARD

▶ WEISS

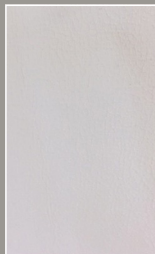

OPTION

▶ OCEAN



▶ CHERRY



▶ PINEAPPLE

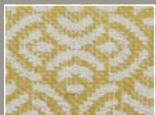

▶ LATTE



▶ STONE



▶ TURQUOISE

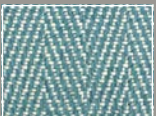

▶ TROPEZIAN



▶ MOKA



INTERIOR WOOD

▶ Standard:
Alpi® Teak

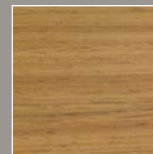

▶ Option:
Alpi® Grey Cedar



FLOOR

▶ Standard: Laminate
ceruse Light Oak



▶ Option:
Dark Oak



WORK SURFACE

▶ Corian



BEDS

▶ Removable
mattress

Cover fabric with Ultra-Fresh® is antimicrobial, anti-bacterial and non-allergenic

EXTERIOR UPHOLSTERY

SPRAYHOOD PROTECTION BIMINI / LAZY BAG



▶ Sunbrella® Plus Taupe



▶ Sunbrella® Plus Oyster



COCKPIT CUSHIONS



▶ Sunbrella® Sling Taupe



▶ Sunbrella® Natté Oyster



**Jeanneau proposes 10 choices oh hull colours and finishes.
Customize your boat !**

HULL WRAPPING

▶ Gloss metallic black

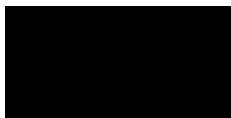

▶ Brushed titanium



▶ Gloss metallic dark bleu



▶ Matte metallic frosty blue



▶ Pearl dark green

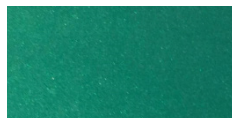

▶ Matte metallic blaze orange



▶ Gloss metallic brown



▶ Gloss burgundy



▶ Gelcoat blanc



▶ Champagne



ADVANTAGES OF VINYL HULL WRAPPING

- Customized
- Unique
- Less expensive than paint
- Repairable
- Many colors and finishes
- Removable
- Easy for the resale

To complete this offer, 45 choices of hull striping are available

HULL STRIPING

▶ 801 Black



▶ 893 Charcoal Metallic



▶ Gloss metallic dark bleu



▶ Blanc



▶ Champagne



LITHIUM BATTERIES

EPSILON – TECHNOLOGY LIFEPO4



GREAT AUTONOMY
100% of useable energy



LIGHT WEIGHT!
With equivalent energy:
More than 65% in weight gain
= reduced volume!



MAXIMUM SERVICE LIFE
≈ 5 000 cycles



TOLERANCE TO HIGH TEMPERATURES



OPTIMUM CONFORT
Compatible with powerful
230V AC/DC inverters!
NO NEED TO COMPROMISE!



SUPER-FAST CHARGING
- 2 hours when under power
1 hour when charging with solar cells
in optimal conditions



PEACE OF MIND
Very low self-discharge,
store your battery safely for
several months

Number of domestic batteries 90 Ah Lithium	
Sun Fast 3200	2
Sun Fast 3600	2

Sun Odyssey 349	1
Sun Odyssey 389	1
Sun Odyssey 410	2
Sun Odyssey 419	2
Sun Odyssey 440	2
Sun Odyssey 490	3

Sun Odyssey 449	2
Sun Odyssey 479	3
Sun Odyssey 519	3

Jeanneau 51	3
Jeanneau 54	3

Sun Odyssey 440-490 Offshore Electronic Pack

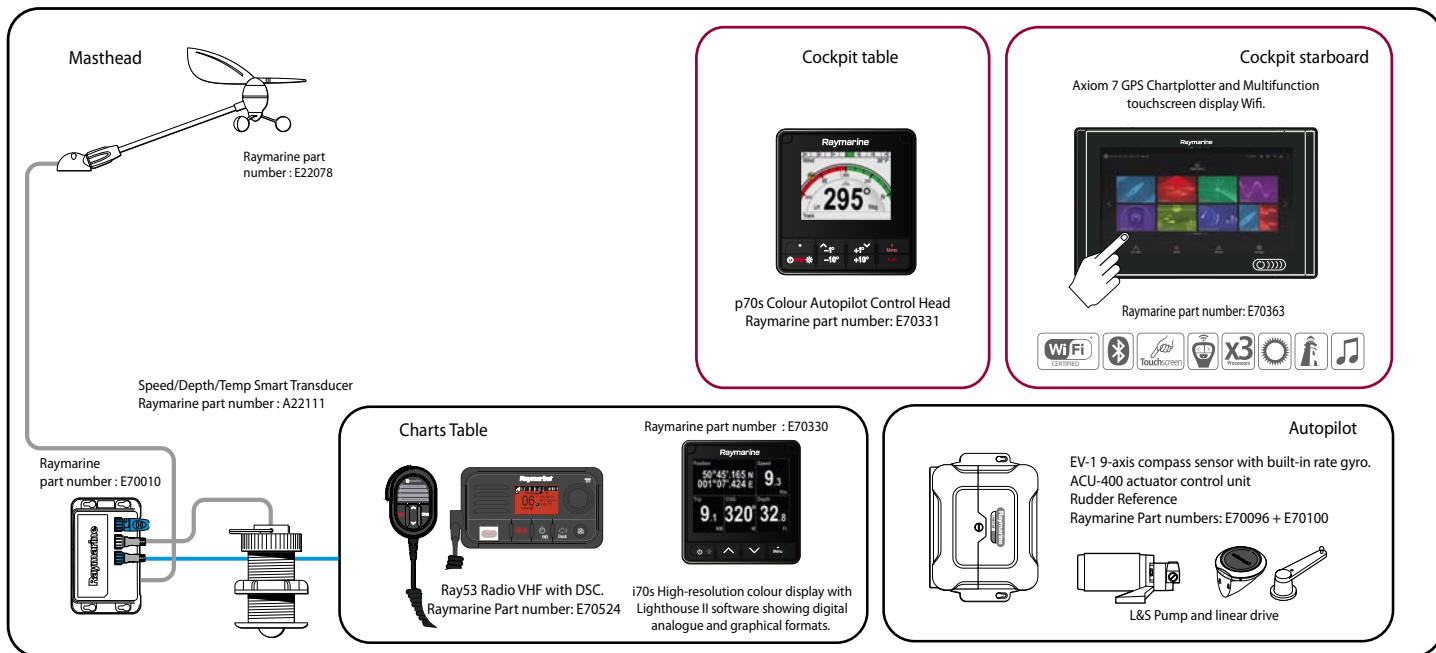

Sun Odyssey 440-490 Offshore Electronic Pack

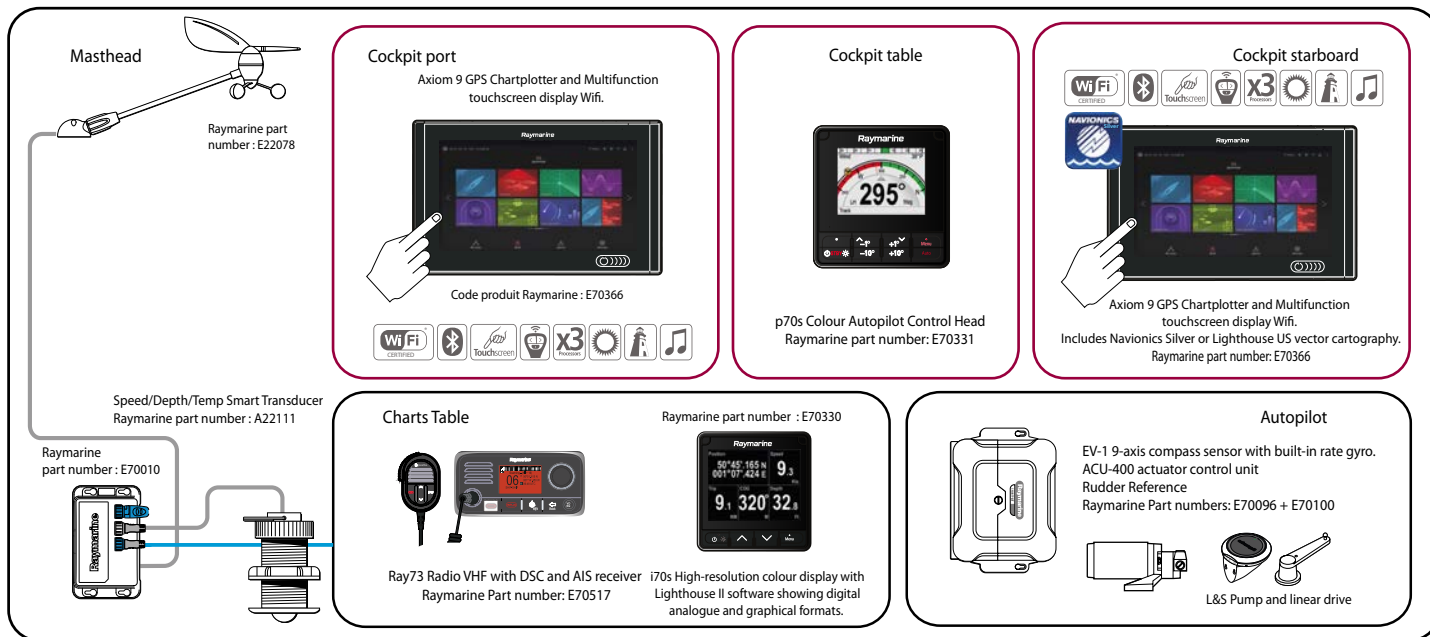

Sun Odyssey 440-490 Ocean Electronic Pack

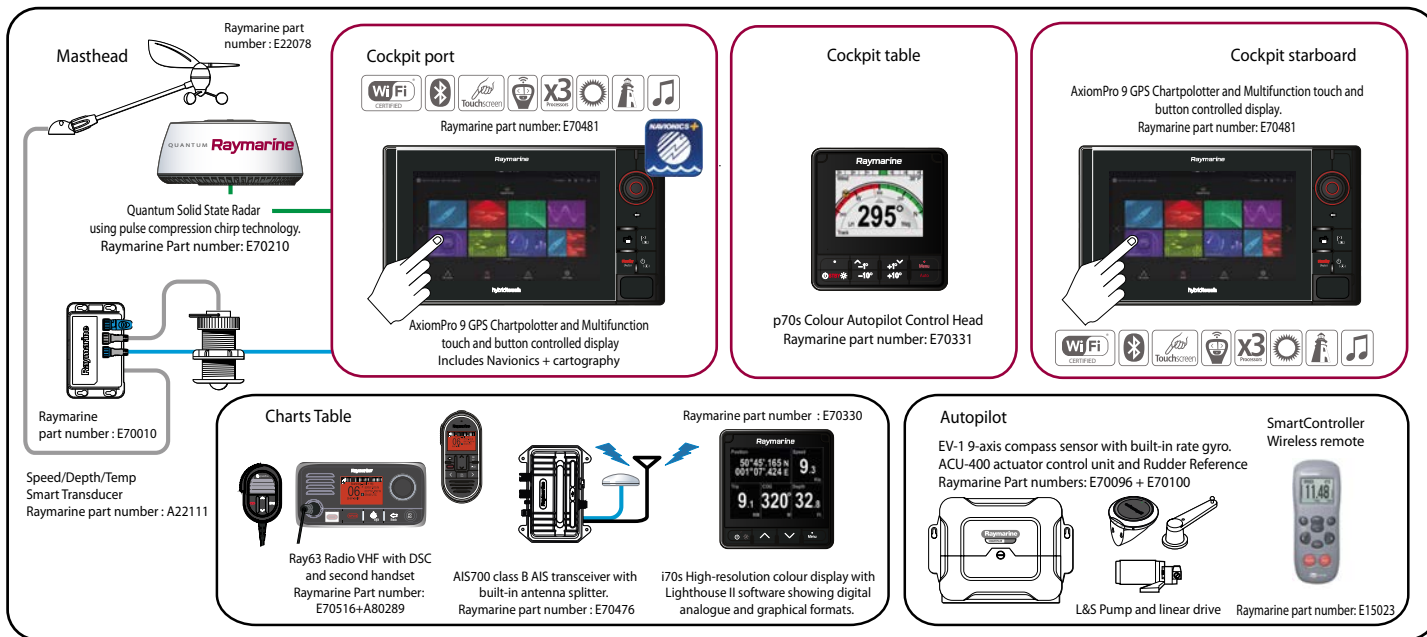

OPTION AST (ASSISTED SAIL TRIM)

Jeanneau's exclusive Assisted Sail Trim technology delivers peace of mind and ease of handling, just like having an additional crew member on board

This exclusive Jeanneau Technology, developed in partnership with Harken, the world's leading deck hardware and sailing equipment supplier.

This innovative system relies on proven equipment and operates in collaboration with major electronics manufacturers.

CONCEPT

This Jeanneau innovation, co-developed in partnership with Harken, allows the sailor to trim the sails and remotely operate the winches directly from a screen at the helm station.

Designed to ensure comfortable and easy sailing, the Assisted Sail Trim system is ideal for short-handed cruising.

100% user-friendly and intuitive, it brings numerous features to cruising in the same way as the autopilot does.

Cette innovation Jeanneau développée en partenariat avec Harken permet de régler les voiles directement depuis un écran au poste de barre et de contrôler les winchs à distance.

Conçu pour le confort de navigation et la sérénité de l'utilisateur, le système ASSISTED SAIL TRIM est idéal pour les navigations en équipage réduit.

100% convivial et intuitif, il apporte de nombreux avantages à la croisière au même titre que le pilote automatique.

1. INITIAL TRIMMING RÉGLAGE INITIAL

The system relies on a correct initial trimming of the sails to the desired heading. This trimming can be adjusted directly from the helm station.

Le système s'appuie sur un réglage initial des voiles selon le cap. Ce réglage peut s'effectuer directement du poste de barre.



2. PROCESSING THE DATA LECTURE DES PARAMETRES

Navigation data (wind, heading, speed...) is collected in real time by the onboard electronics.

Les données de navigation (vent, cap, vitesse...) sont captées en temps réel par la centrale électronique.

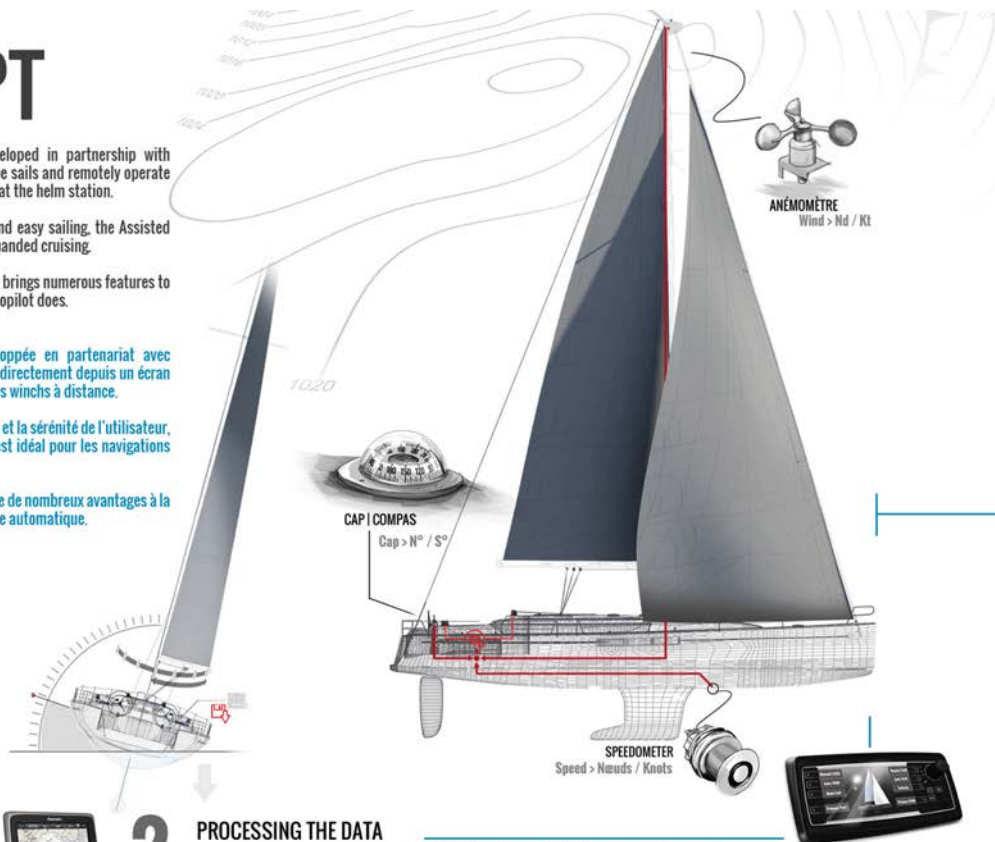



3. SAIL AND WINCH CONTROL GESTION DES VOILES ET DES WINCHS

The AST system's internal computer compiles this data and drives the winches to trim the sails.

Le système AST compile ces données dans un calculateur et pilote les winchs pour régler les voiles.

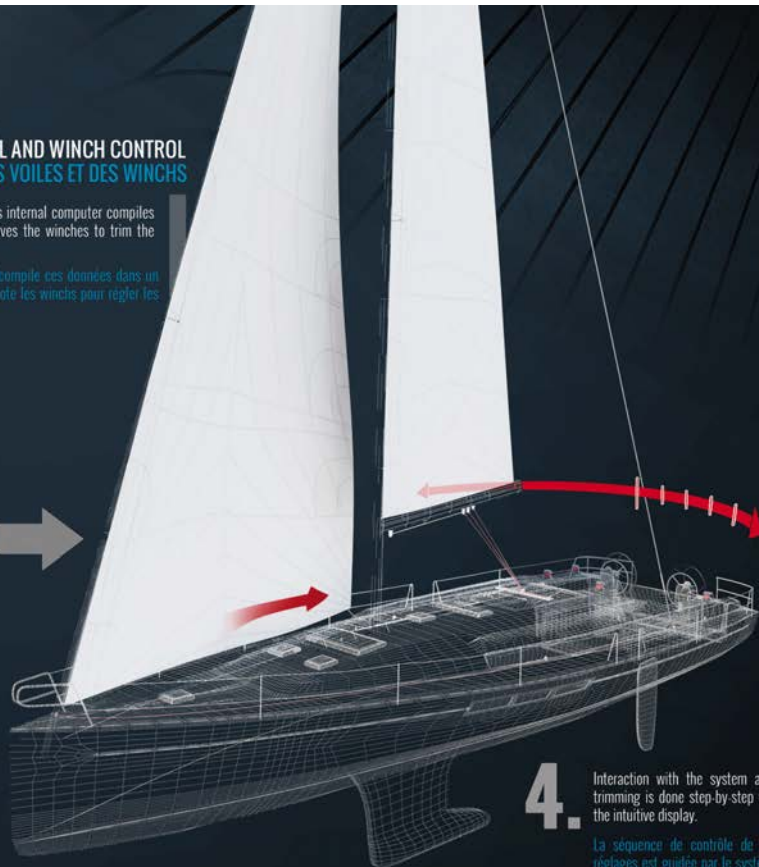

4. Interaction with the system and trimming is done step-by-step via the intuitive display.

La séquence de contrôle de ces réglages est guidée par le système via un écran très intuitif.

AUTO TRIM

REGULATEUR

1.

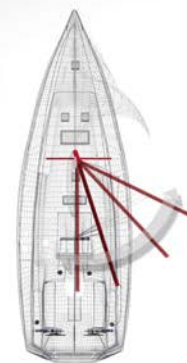

As the heading changes, the sails are adjusted automatically to maintain proper trim.

En fonction des variations de cap, les voiles se réglent automatiquement pour conserver un bon réglage.

TRIM THE SAILS
REGLEZ LES VOILES

2.



ACTIVATE AUTO TRIM
ACTIVER L'AUTO TRIM

3.



SO EASY TO SAIL
TELLEMENT SIMPLE

Alternatively, if the boat maintains a given heading under autopilot and wind angle changes, the sails will automatically be trimmed accordingly.

Ideal for long distances cruises, this system is comparable to the cruise control function in a car.

Autre cas de figure, si le bateau suit un cap donné sous pilote automatique et si le vent tourne, les voiles seront réglées automatiquement en conséquence.

Idéal pour longues distances, ce système est comparable avec un régulateur de vitesse de voiture.

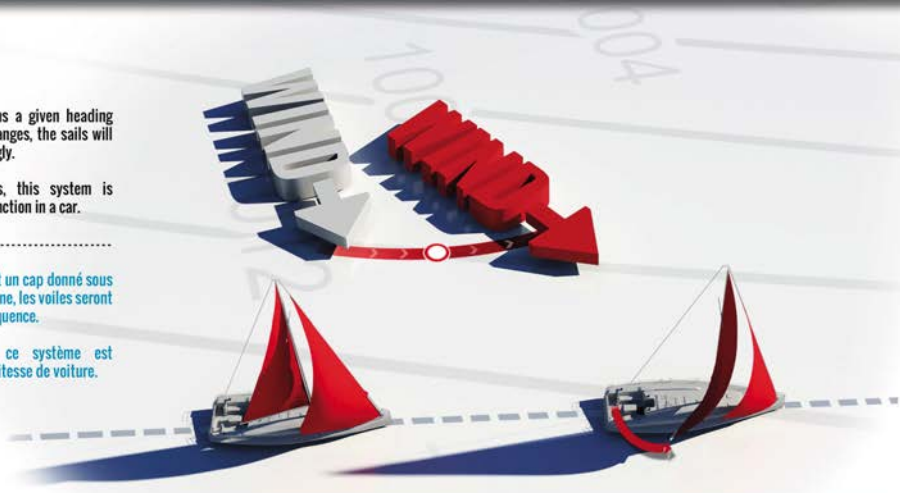
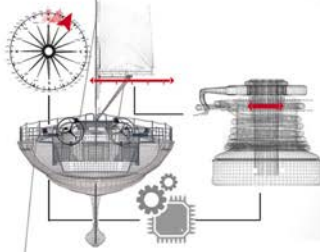

AUTO TACK

VIREMENT DE BORD ASSISTÉ

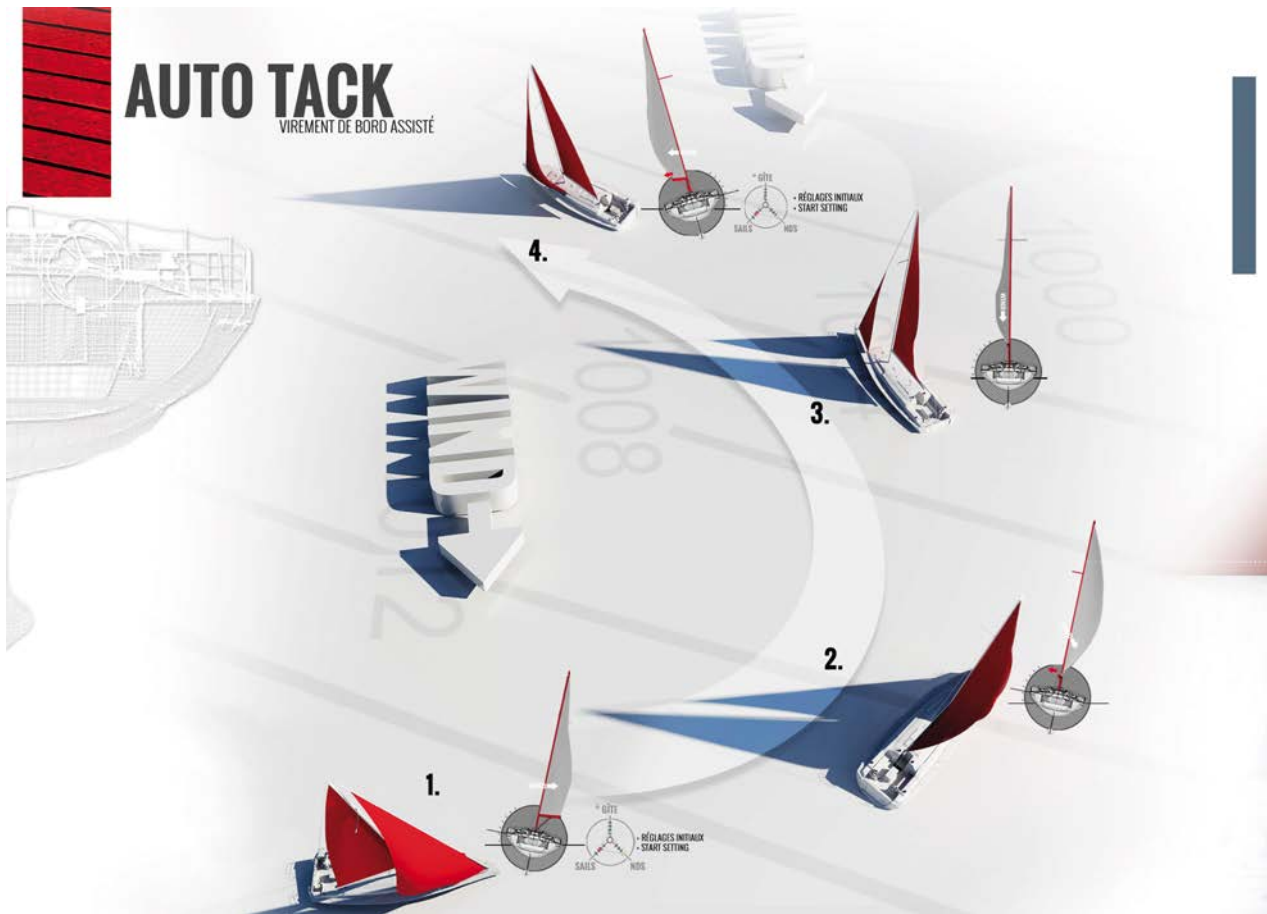

The helmsperson pushes the Auto Tack button, and turns the wheel to tack the boat.

The system automatically operates the primary winches to pull in one sheet and ease the other.

Sails are trimmed to the same angle as before the turn, but on the opposite tack.

L'utilisateur appuie sur le bouton auto tack et manœuvre la barre à roue pour que le bateau vire.

Le système gère automatiquement les winchs d'écoutes de génôis pour choquer d'un côté et border de l'autre.

Le système retrouve le réglage de voiles défini avant le virement de bord.



1. TRIM THE SAILS
REGLEZ LES VOILES



2. ACTIVATE AUTO TACK
ACTIVEZ L'AUTO TACK



3. TURN THE WHEEL
TOURNEZ LA BARRE



4. TACK FINISHED
VIREMENT TERMINE



HEEL LIMITER

LIMITER LA GÎTE

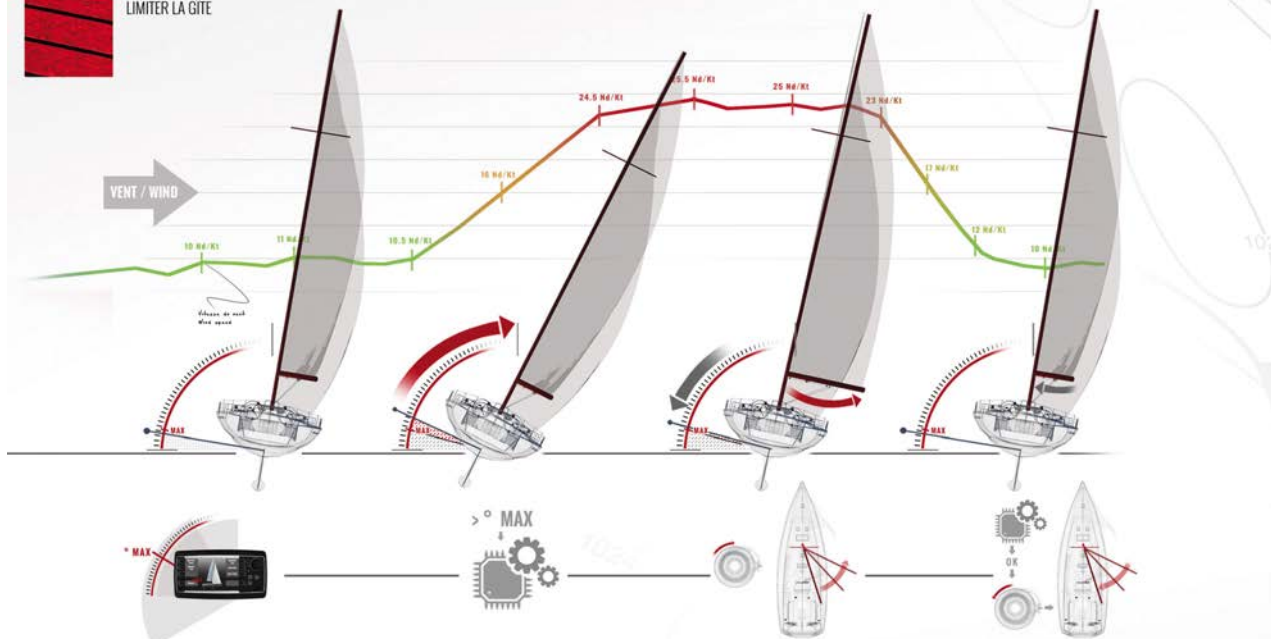

While the boat is sailing on a given course, the sails should be properly trimmed and the Auto Trim function activated.

Le bateau navigue selon un cap donné avec des voiles correctement réglées et la fonction Auto Trim activée.

If the wind increases and the heel reaches a pre-defined angle, the system automatically eases the mainsheet.

Si le vent augmente et que la gîte atteint la limite définie, le système choque automatiquement la grand voile.

Once the boat comes back to a more comfortable angle of heel, the mainsheet is trimmed in automatically to its original position.

Une fois que le bateau retrouve une gîte plus confortable, la voile est à nouveau automatiquement bordée.

